

7551 Kraft Crescent,  
Burnaby, B.C.

**Totals \*\***

Main Level:	1,533 sq. ft.
Lower Level:	1,066 sq. ft.
Total:	2,599 sq. ft.
Cold Storage:	59 sq. ft.
Grand Total:	2,658 sq. ft.

**Other Areas**

Garage:	408 sq. ft.
Deck:	141 sq. ft.
Patio:	621 sq. ft.
Lower Patio:	67 sq. ft.
Total:	1,237 sq. ft.

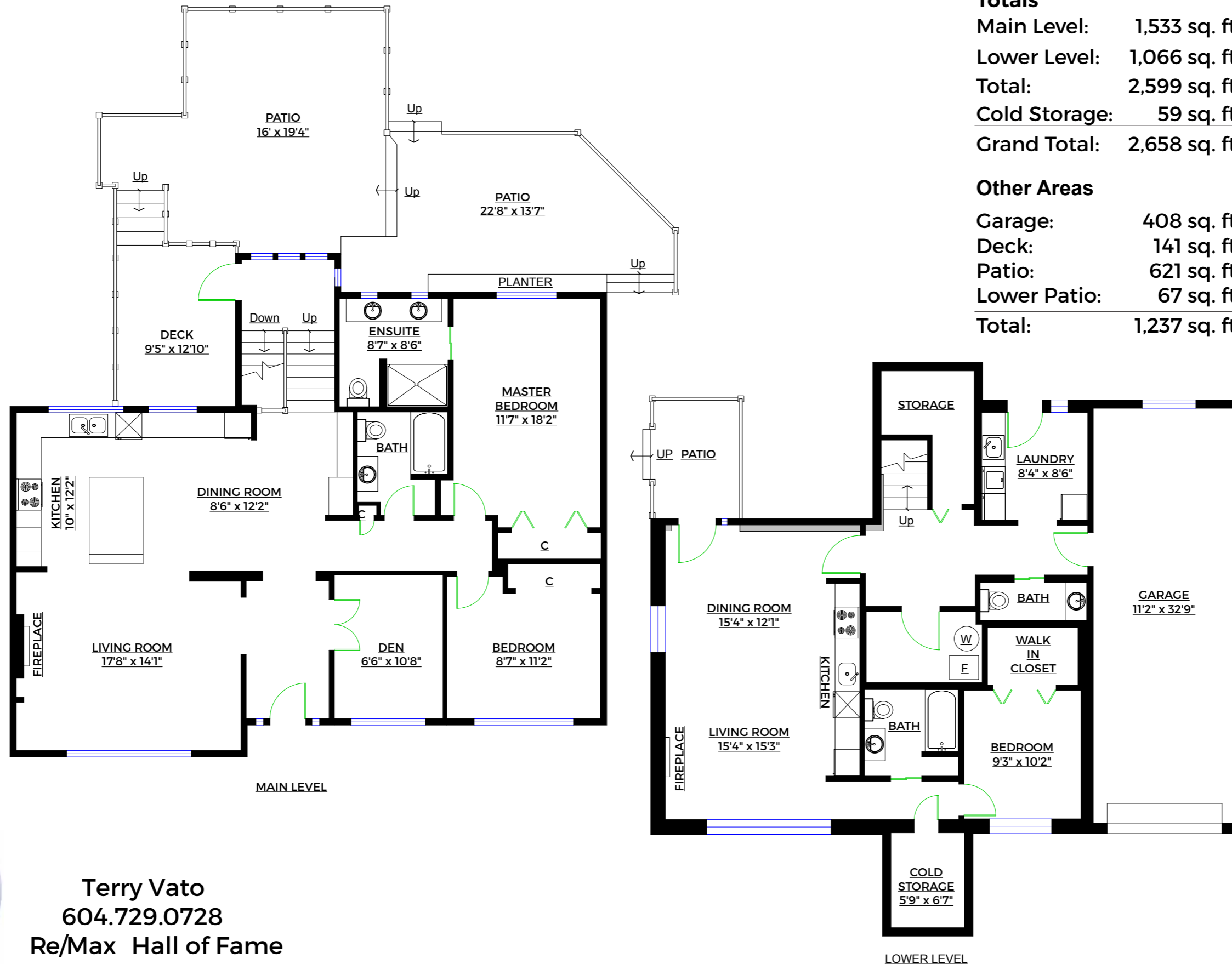

Terry Vato  
604.729.0728  
Re/Max Hall of Fame  
www.TerryVato.com

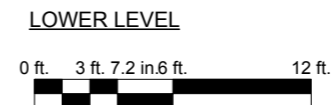

\*\* Approx. based on interior measurements to exterior walls  
\*\* Total square footage not taken from original blueprints

