

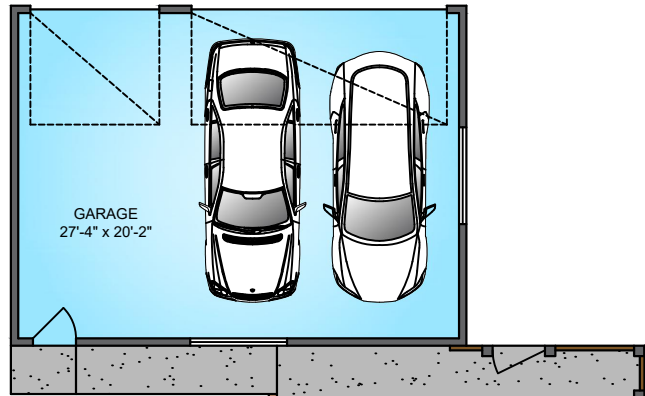

**DETACHED
GARAGE
596 SQ. FT.**

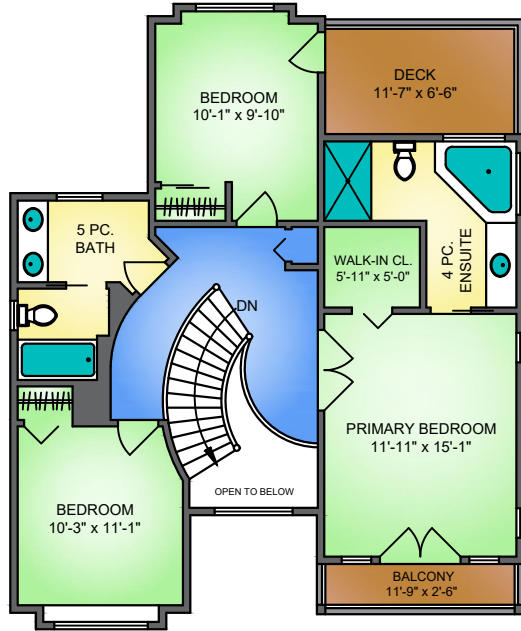

**UPPER FLOOR
882 SQ. FT.
8'0" CEILING**



**MAIN FLOOR
1,157 SQ. FT.
8'11" CEILING**

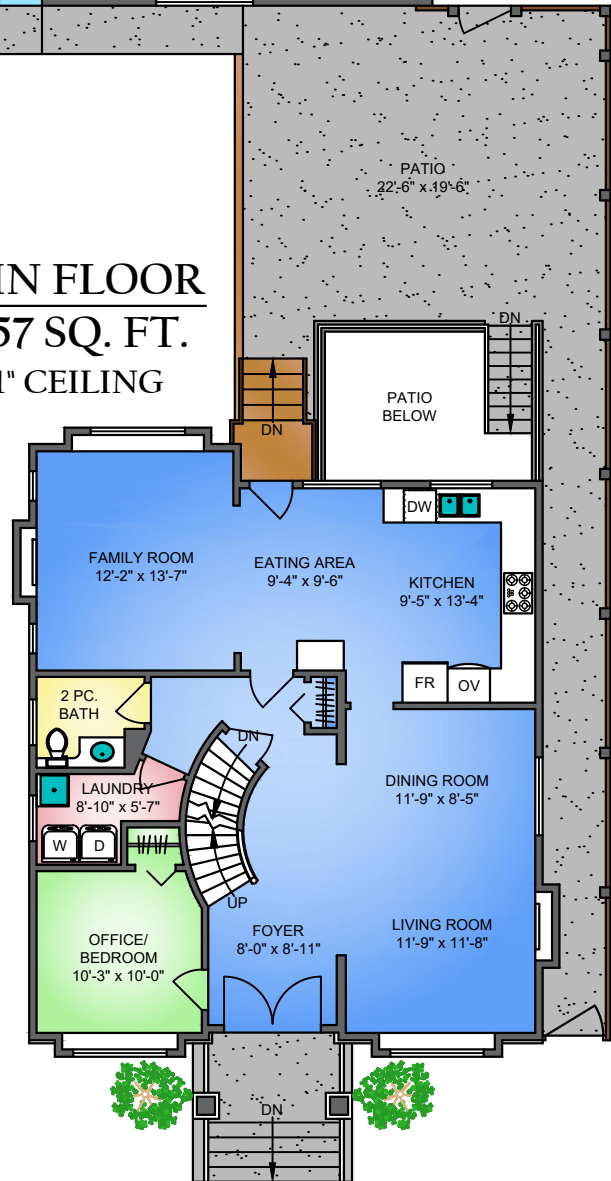

**LOWER FLOOR
894 SQ. FT.
7'11" CEILING**

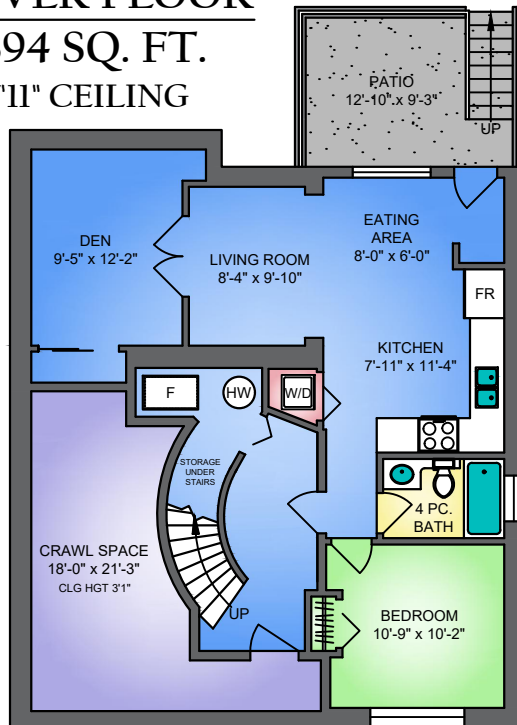

3506 HAIDA DRIVE, VANCOUVER

APRIL 15, 2026

PREPARED BY PROPER MEASURE.

FOR THE EXCLUSIVE USE OF IRENE WONG AND MIKE MULLIGAN.

AREA (SQ. FT.)

FLOOR	FINISHED	CRAWL SPACE	GARAGE	DECK / PATIO
MAIN	1157		596	446
UPPER	882			105
LOWER	894	240		119
TOTAL	2933	240	596	670

