

TERRI AND DON WEBER
 Prudential Sussex Realty - Terri & Don Weber
 2397 Marine Drive
 West Vancouver, BC V7V 1K9
 T: 604-802-5460
 E: terri@terriweber.com
 www.terriweber.com

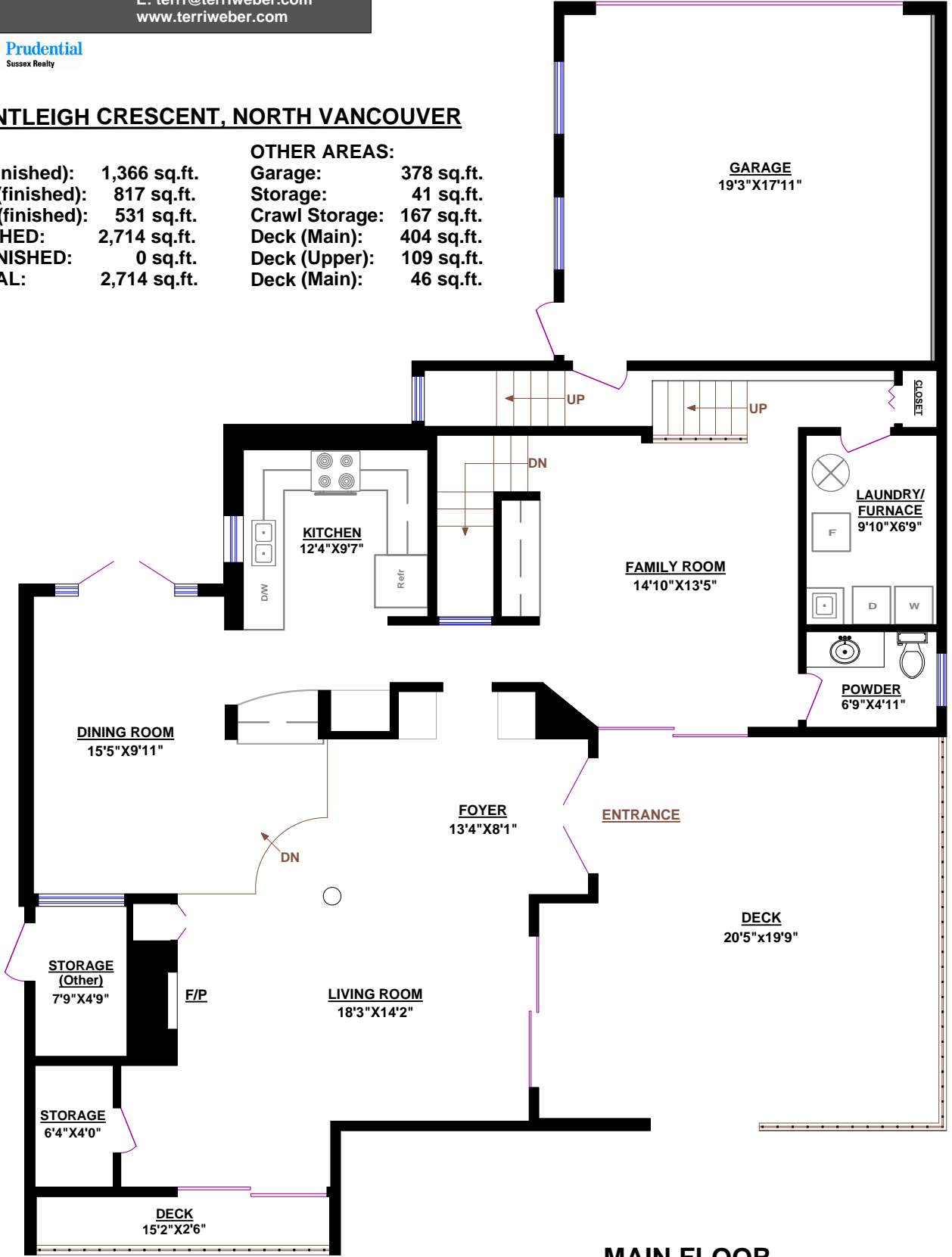

3214 HUNTLEIGH CRESCENT, NORTH VANCOUVER

TOTALS		
Main Floor (finished):	1,366 sq.ft.	OTHER AREAS:
Upper Level (finished):	817 sq.ft.	Garage: 378 sq.ft.
Lower Level (finished):	531 sq.ft.	Storage: 41 sq.ft.
TOTAL FINISHED:	2,714 sq.ft.	Crawl Storage: 167 sq.ft.
TOTAL UNFINISHED:	0 sq.ft.	Deck (Main): 404 sq.ft.
GRAND TOTAL:	2,714 sq.ft.	Deck (Upper): 109 sq.ft.
		Deck (Main): 46 sq.ft.



MAIN FLOOR

