

**5341 Aspen Drive,
West Vancouver, B.C.**

Totals**

Main Level: 1,079 sq. ft.
Upper Level: 1,446 sq. ft.
Total: 2,525 sq. ft.

Crawl Space: 384 sq. ft.
Storage: 74 sq. ft.
Garage: 434 sq. ft.
Patio: 321 sq. ft.
Total: 1,213 sq. ft.



Franco Diligenti
604.842.2668

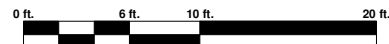
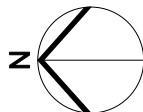
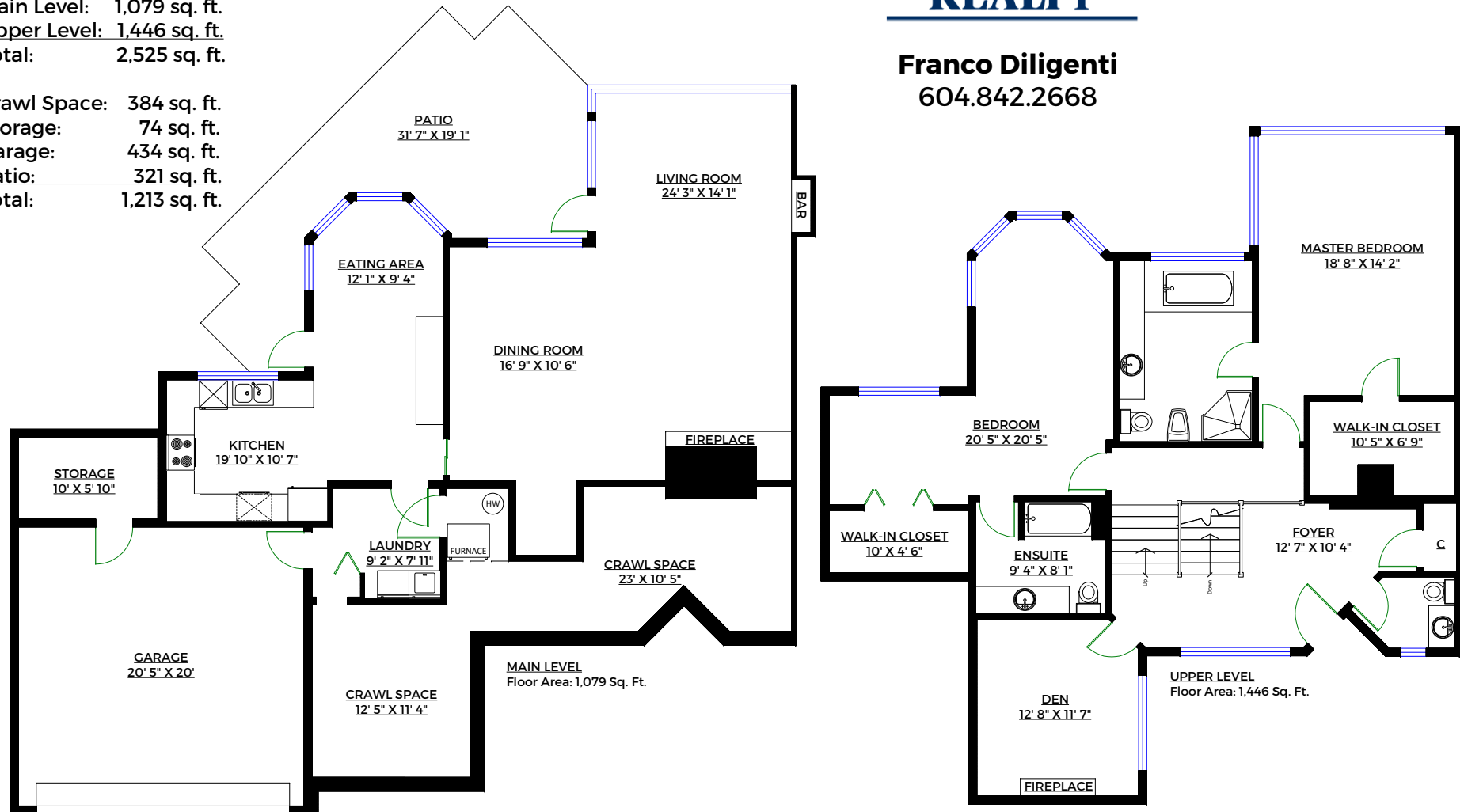

** Approx. based on interior measurements to exterior walls
** Total square footage not taken from original blueprints