

**STRATA PLAN OF LOT D,
BLOCK 2, D.L. 391 AND 392,
N.W.D., REF. PLAN 22949**

STRATA PLAN LMS

CITY OF VANCOUVER
B.C.G.S. 92G.025

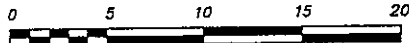

SCALE 1 : 250 DISTANCES ARE METRIC

LEGEND :

- SL DENOTES STRATA LOT
- m² DENOTES SQUARE METRES
- ⊙ DENOTES COMMON PROPERTY
- ⊙ DENOTES TERRACE BEING LIMITED COMMON PROPERTY FOR EXCLUSIVE USE OF ADJOINING STRATA LOT
- RES DENOTES LIMITED COMMON PROPERTY (RESIDENTIAL) FOR EXCLUSIVE USE OF STRATA LOTS 1,2,3 AND SL.9 THROUGH SL.36 INCLUSIVE
- COM DENOTES LIMITED COMMON PROPERTY (COMMERCIAL) FOR EXCLUSIVE USE OF STRATA LOTS 4 THROUGH 8 INCLUSIVE



DEPOSITED AND REGISTERED IN THE LAND
TITLE OFFICE AT NEW WESTMINSTER B.C.
THIS ___ DAY OF _____ 1995

REGISTRAR

CIVIC ADDRESS :

4828 - 4858 FRASER STREET
703 - 707 DURWARD AVENUE
VANCOUVER, B.C.

LEGEND

- ⊙ DENOTES OLD CONTROL MONUMENT
- DENOTES OLD IRON POST FOUND
- DENOTES IRON POST SET
- DENOTES OLD LEAD PLUG FOUND

INTEGRATED SURVEY AREA No.31 CITY OF VANCOUVER
THIS PLAN SHOWS GROUND - LEVEL MEASURED DISTANCES
PRIOR TO COMPUTATION OF UTM CO-ORDINATES MULTIPLY
BY COMBINED FACTOR 0.9995917

GRID BEARINGS ARE DERIVED FROM OBSERVATIONS BETWEEN
CONTROL MONUMENTS V-1812 COMBINED FACTOR 0.9995922
AND V-1690 COMBINED FACTOR 0.9995917

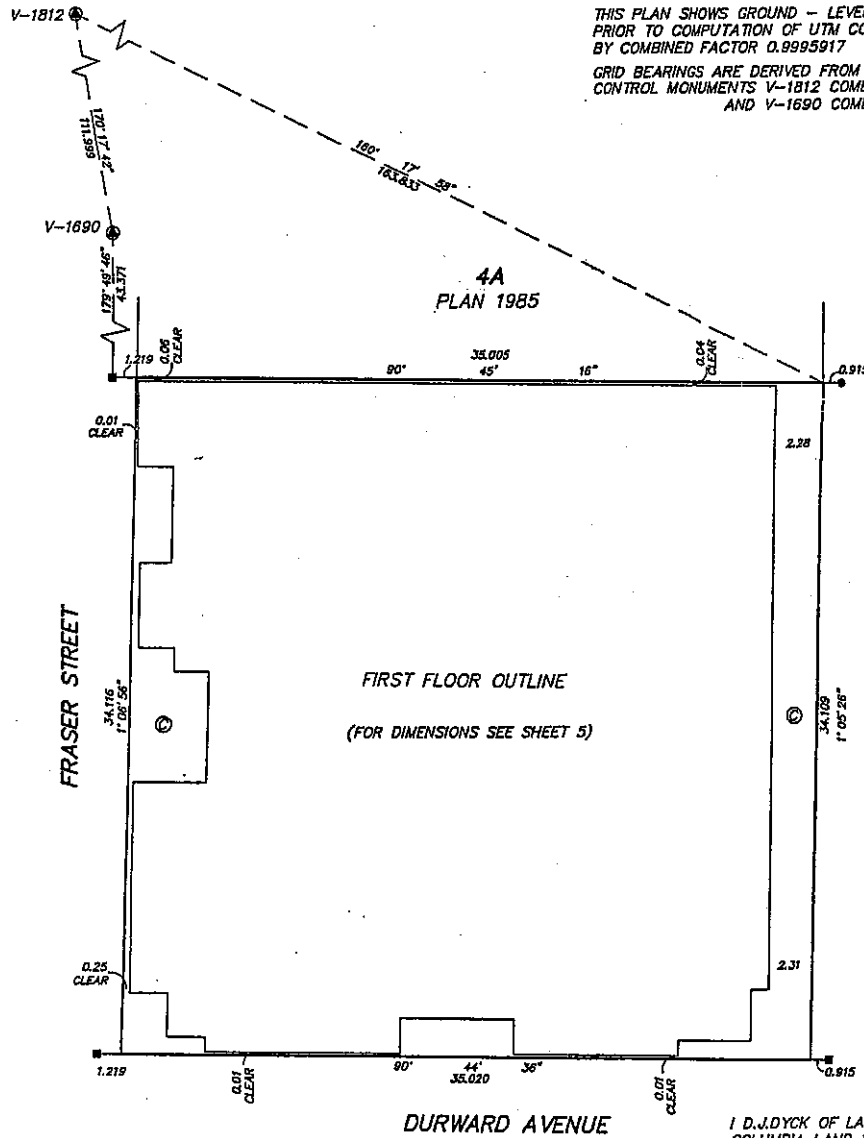

THE ADDRESS FOR SERVICE OF DOCUMENTS
OF THE STRATA CORPORATION IS :
THE OWNERS, STRATA PLAN LMS _____
c/o SUITE 300 - 68 EAST 2nd AVENUE
VANCOUVER, B.C., V5T 1B1

I D.J.DYCK OF LANGLEY, B.C. A BRITISH
COLUMBIA LAND SURVEYOR HEREBY CERTIFY
THAT THE BUILDING ERECTED ON THE PARCEL
DESCRIBED ABOVE IS WHOLLY WITHIN THE
EXTERNAL BOUNDARIES OF THAT PARCEL
DATED AT SURREY, B.C.
THIS 2nd DAY OF FEBRUARY, 1995

D. Dyck

B.C.L.S.

THIS PLAN LIES WITHIN THE GREATER
VANCOUVER REGIONAL DISTRICT

DYCK AND ASSOCIATES
208 - 6846 - KING GEORGE HIGHWAY
SURREY, B. C. V3W 4Z9
594-7527 FAX 594-7932

FILE: 95-1968-S

FLOOR PLANS

STRATA PLAN LMS

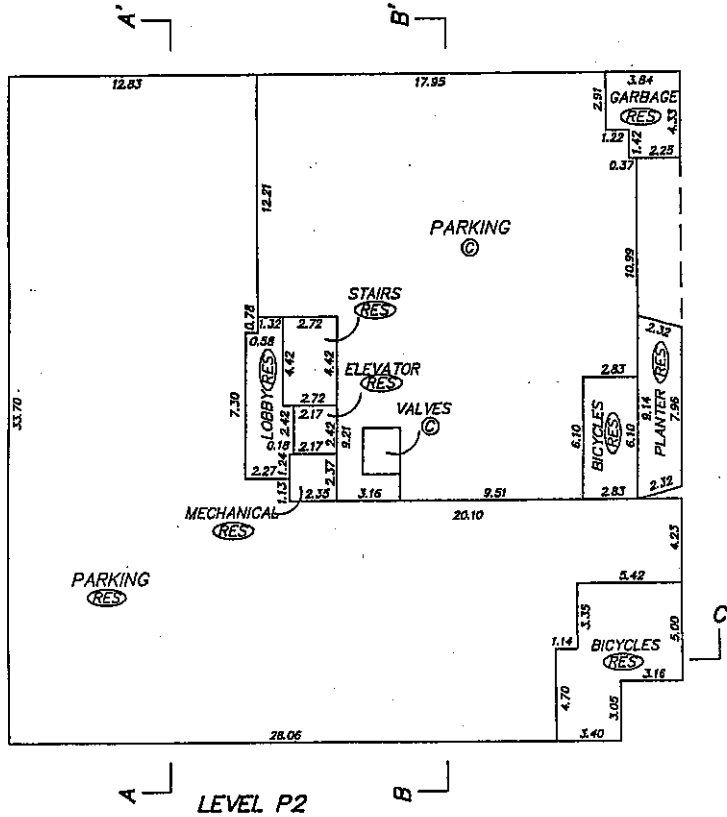
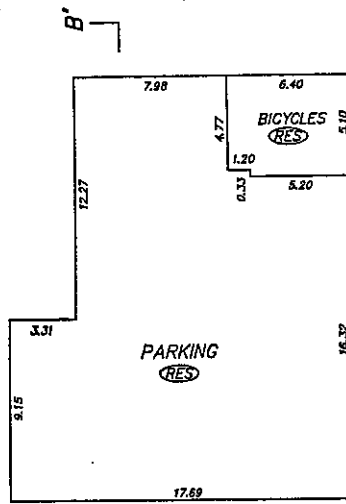
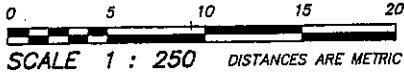

sl
FEB. 2, 1995
FILE: 94-1968-S

FLOOR PLANS

STRATA PLAN LMS

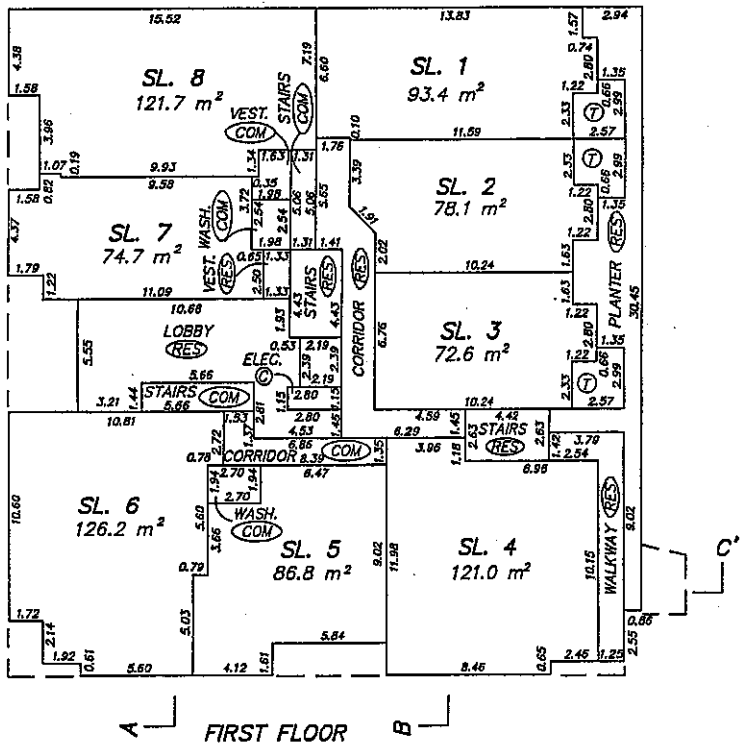
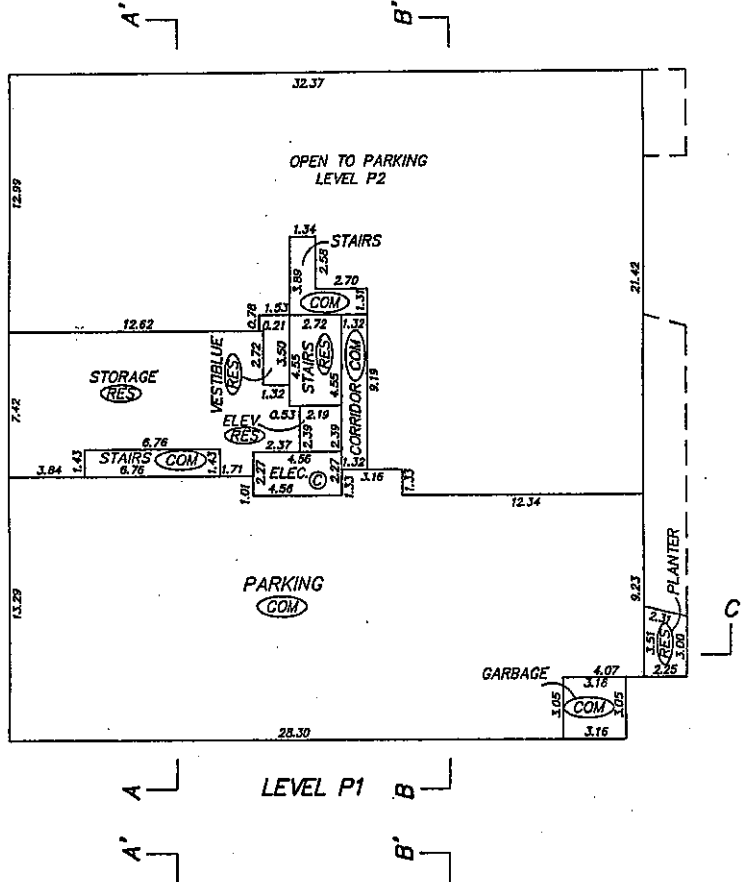
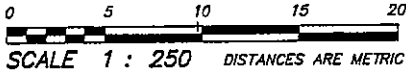

FLOOR PLANS

STRATA PLAN LMS

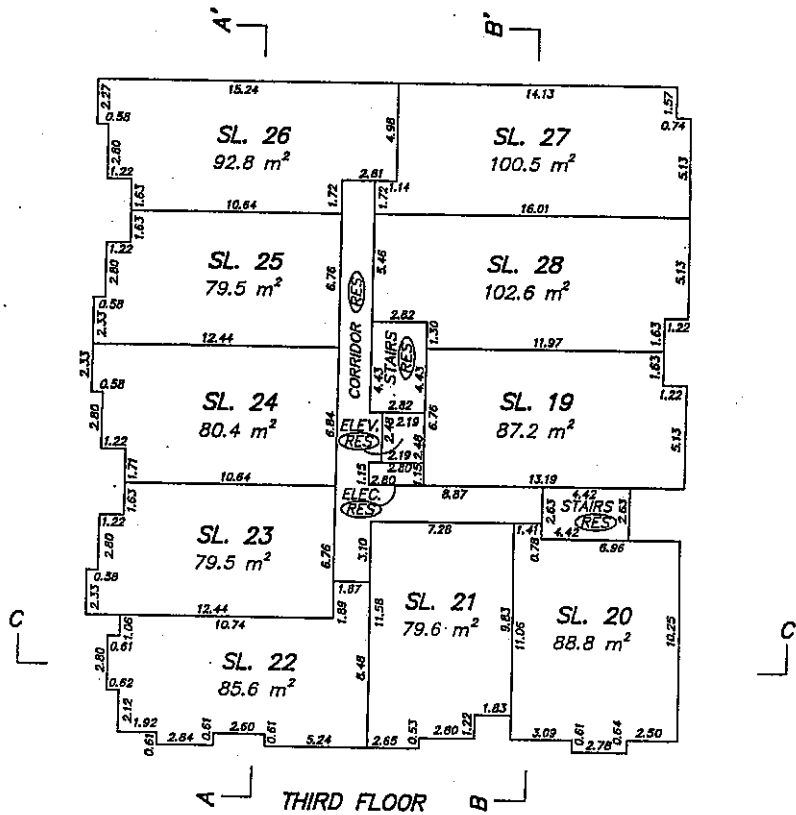
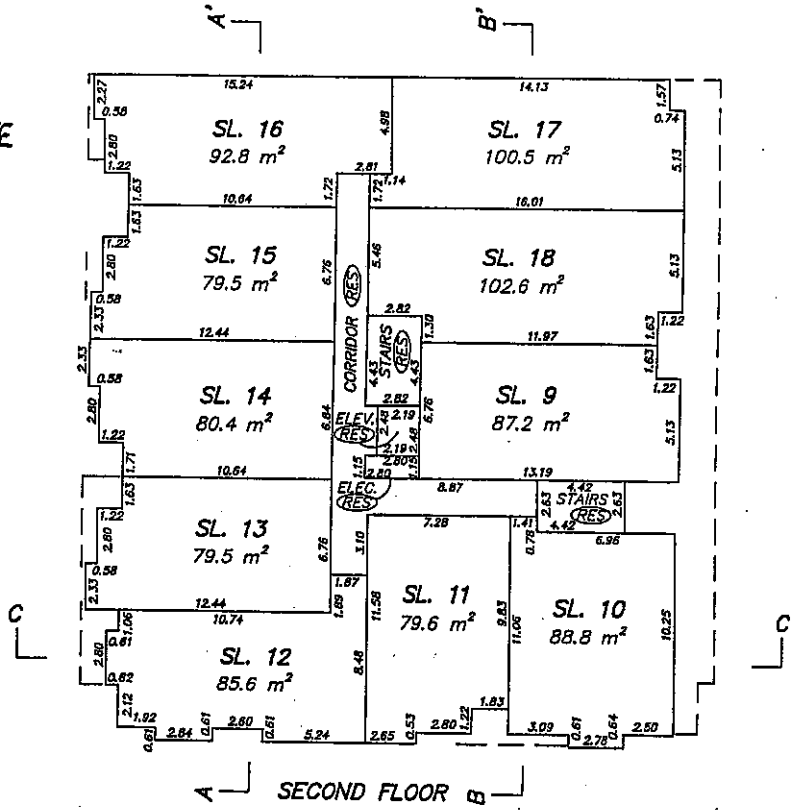
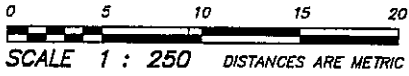

sl
FEB. 2, 1995
FILE: 94-1968-S

FLOOR PLANS

STRATA PLAN LMS

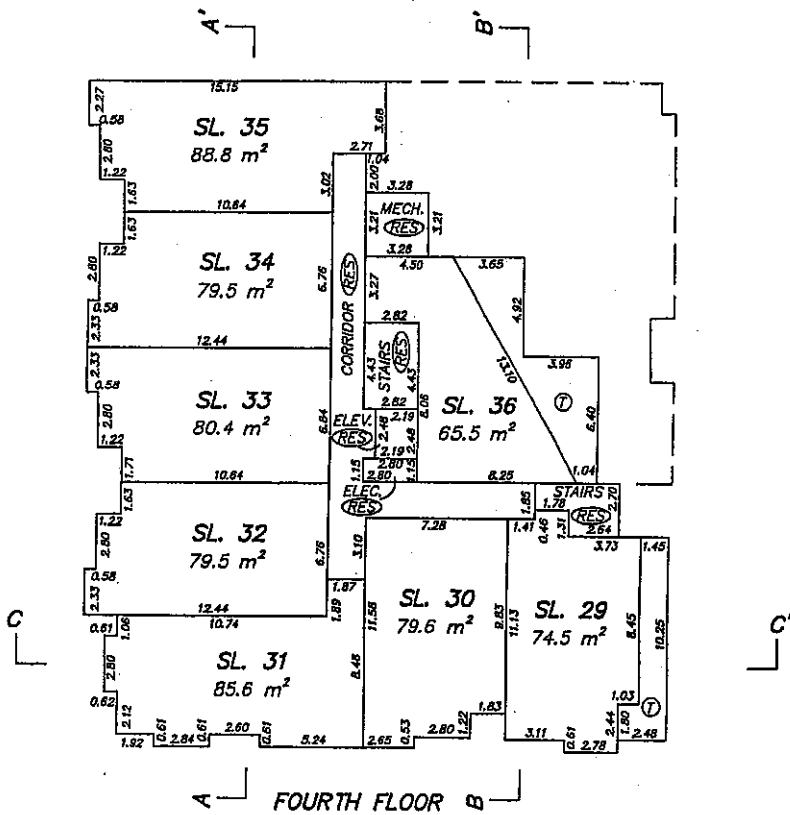
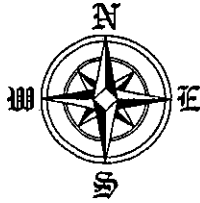
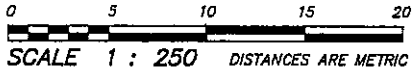

SECTIONS

STRATA PLAN LMS

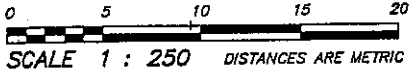

FOURTH FLOOR	SL. 31	SL. 32	SL. 33	SL. 34	SL. 35
THIRD FLOOR	SL. 22	SL. 23	SL. 24	SL. 25	SL. 26
SECOND FLOOR	SL. 12	SL. 13	SL. 14	SL. 15	SL. 16
FIRST FLOOR	SL. 6		LOBBY (RES)	SL. 7	SL. 8
LEVEL P1	PARKING (COM)		STAIRS (COM)	STORAGE (RES)	
LEVEL P2	PARKING (RES)				

SECTION A - A'

FOURTH FLOOR	SL. 29	SL. 36 (T)		
THIRD FLOOR	SL. 20	SL. 19	SL. 28	SL. 27
SECOND FLOOR	SL. 10	SL. 9	SL. 18	SL. 17
FIRST FLOOR	SL. 4	SL. 3	SL. 2	SL. 1
LEVEL P1	PARKING (COM)	PARKING (C)		
LEVEL P2	PARKING (RES)	PARKING (RES)		
LEVEL P3		PARKING (RES)		

SECTION B - B'

FOURTH FLOOR	SL. 31	SL. 30	SL. 29 (T)	
THIRD FLOOR	SL. 22	SL. 21	SL. 20	
SECOND FLOOR	SL. 12	SL. 11	SL. 10	
FIRST FLOOR	SL. 6	SL. 5	SL. 4	WALKWAY (RES) PLANTER (RES)
LEVEL P1	PARKING (COM)			PLANTER (RES)
LEVEL P2	PARKING (RES)			BICYCLES (RES)

SECTION C - C'