

17294 2nd Avenue Surrey V3Z 9P9

ABOVE MAIN	871 SQ FT
MAIN FLOOR	878 SQ FT
FINISHED AREA	1,749 SQ FT

UNFINISHED BASEMENT	871 SQ FT
TOTAL AREA	2,610 SQ FT

PATIO*	204 SQ FT
GARAGE*	368 SQ FT
COVERED DECK*	313 SQ FT

COACH MAIN FLOOR*	502 SQ FT
COACH LOWER FLOOR*	47 SQ FT
COACH HOUSE TOTAL*	549 SQ FT

PARKING/APRON* 313 SQ FT
 *NOT INCLUDED IN TOTAL AREA CALCULATIONS

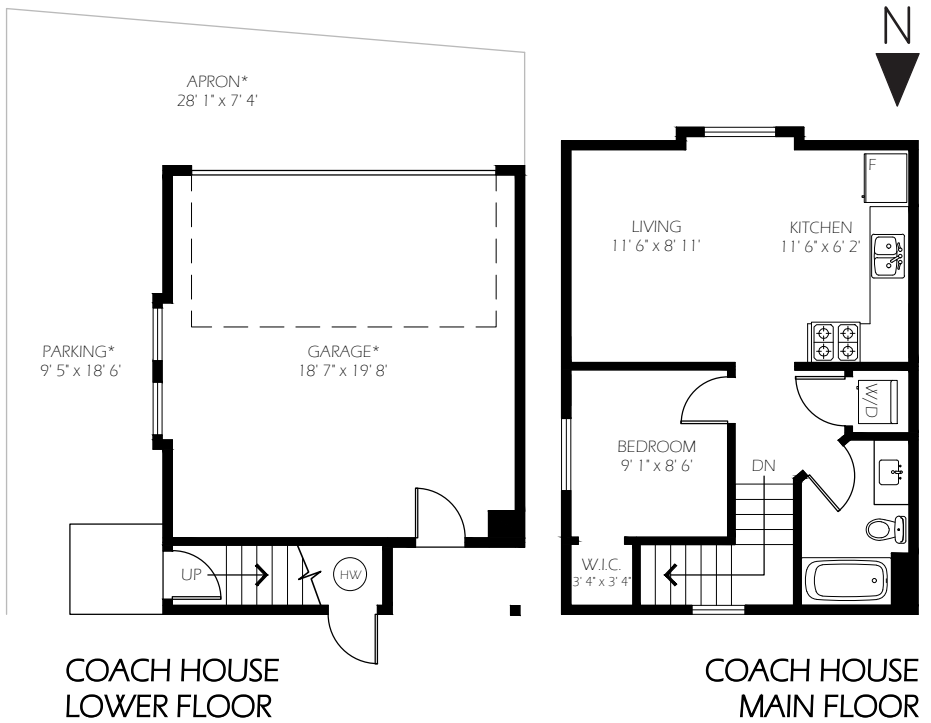

Evon Mayer

REAL ESTATE SALES REPRESENTATIVE
 evon@evonmayer.com | 604.418.5786

