

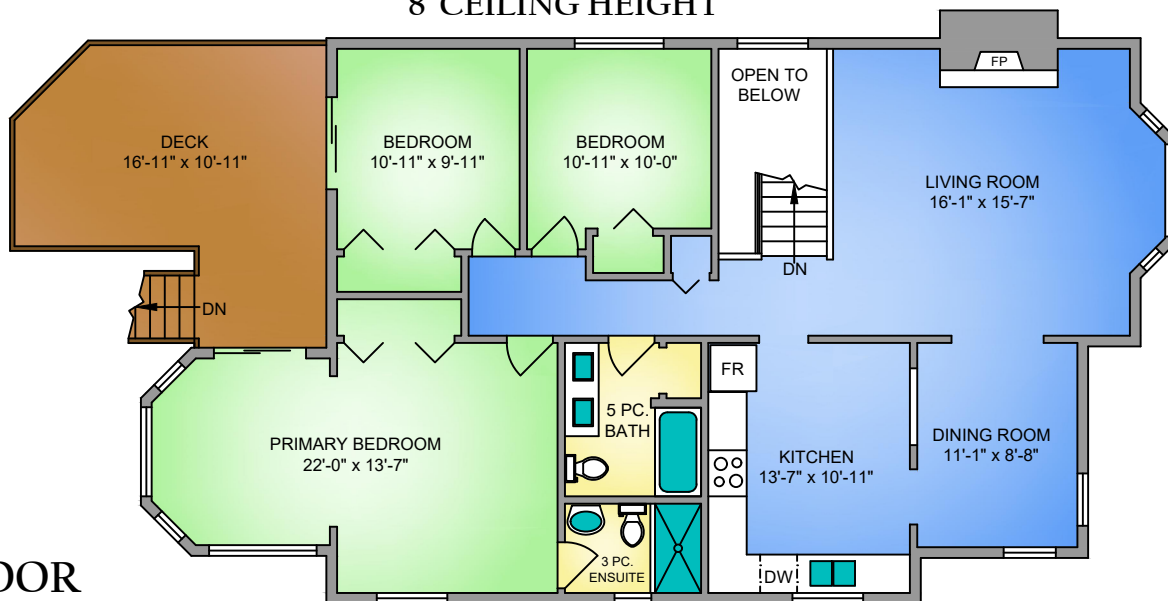

SECOND FLOOR

1359 SQ. FT.

8' CEILING HEIGHT



FIRST FLOOR

709 SQ. FT.

8' CEILING HEIGHT

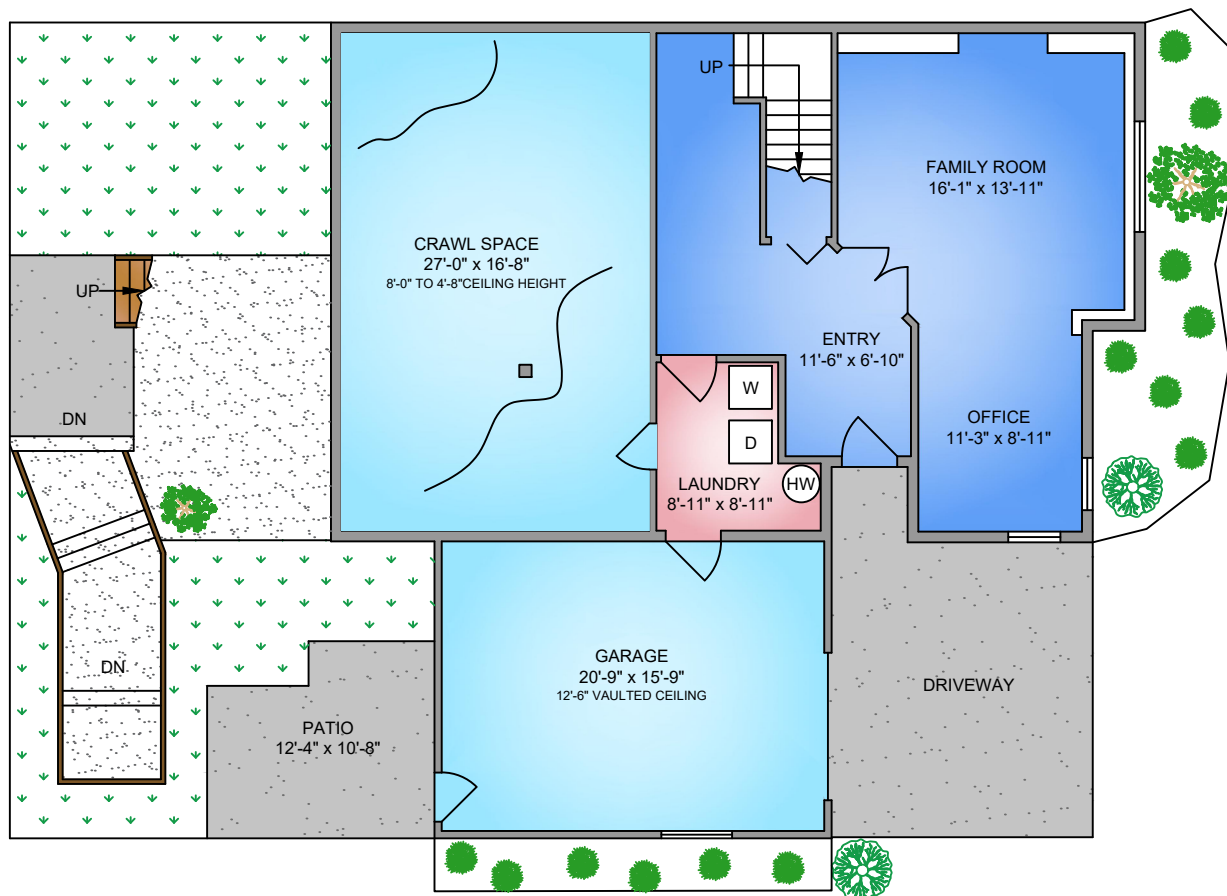

NORTH

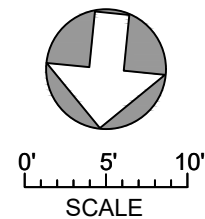

250-884-9753

matt@propermeasure.com

www.propermeasure.com

2395 CEDAR RIDGE DRIVE

MARCH 25, 2021

PREPARED FOR THE EXCLUSIVE USE OF TIM AYERS

PLANS MAY NOT BE 100% ACCURATE, IF CRITICAL BUYER TO VERIFY.

FLOOR	AREA (SQ. FT.)			
	FINISHED	CRAWL	GARAGE	DECK / PATIO
SECOND	1359	-	-	214
FIRST	709	486	347	119
TOTAL	2068	486	347	333