

MAIN FLOOR

1680 SQ. FT.

8' CEILING HEIGHT

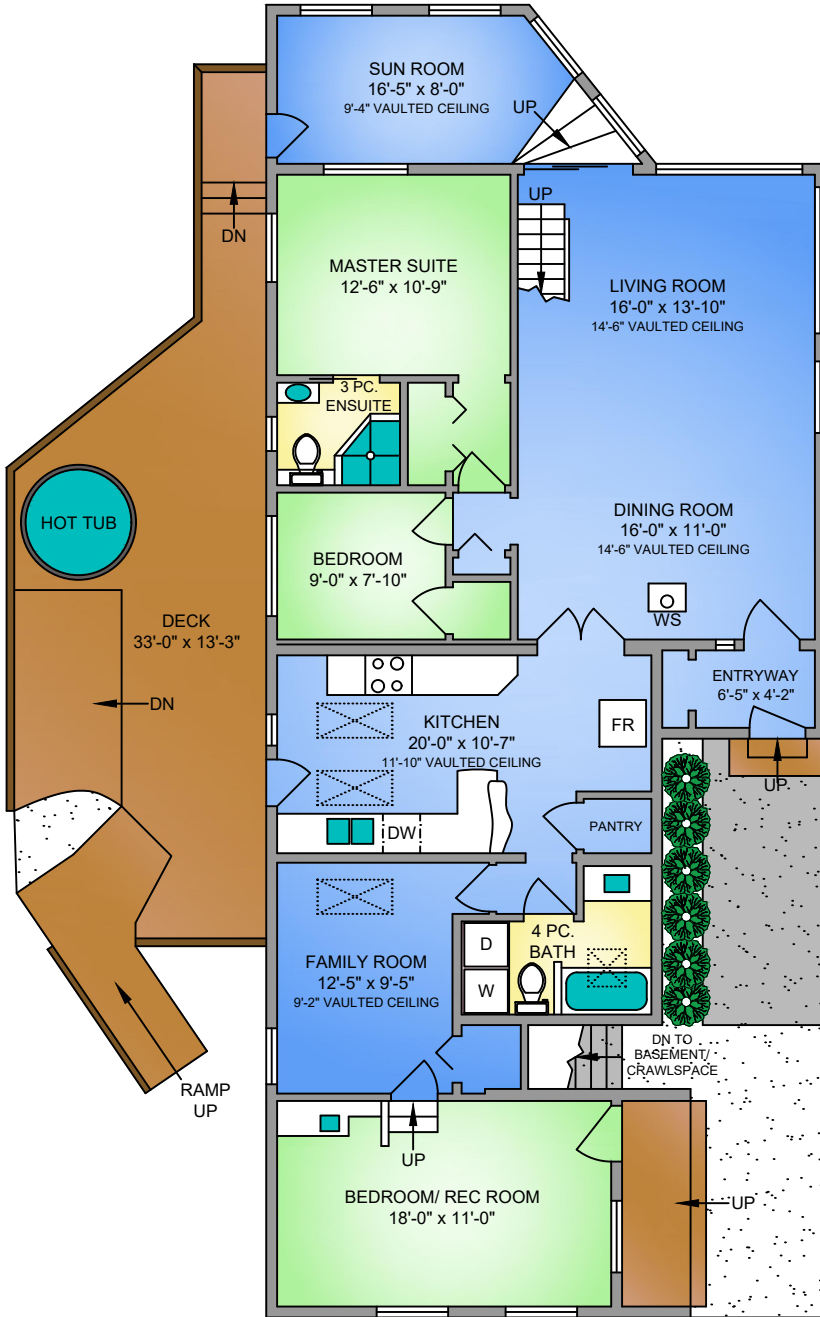

UPPER FLOOR

245 SQ. FT.

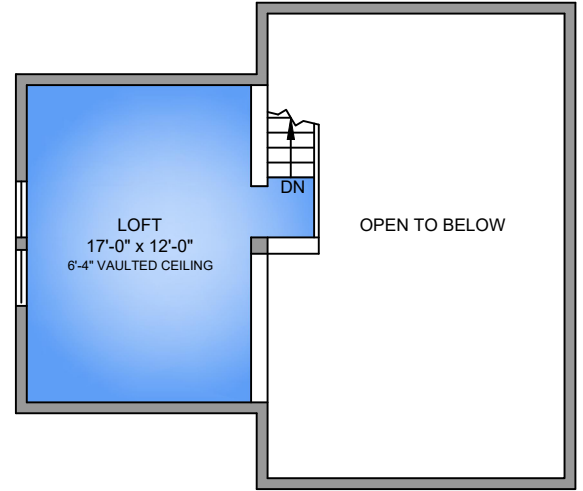

LOWER FLOOR

134 SQ. FT.

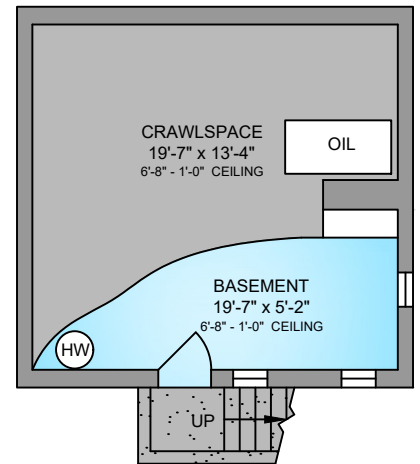

GARAGE

677 SQ. FT.

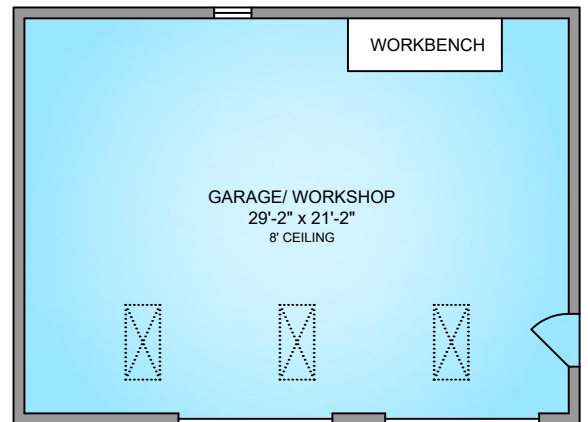

NORTH

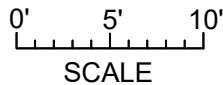
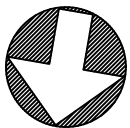

250-884-9753
matt@propermeasure.com
www.propermeasure.com



3013 MANZER ROAD

MAY 6, 2019

PREPARED FOR THE EXCLUSIVE USE OF TIM AYRES
PLANS MAY NOT BE 100% ACCURATE, IF CRITICAL BUYER TO VERIFY.

FLOOR	AREA (SQ. FT.)			
	FINISHED	UNFINISHED	GARAGE	DECK / PATIO
MAIN	1680	-	677	308
UPPER	245	-	-	-
LOWER	-	134	-	-
TOTAL	1925	134	677	308