

STRATA PLAN OF LOT A,
SECTION 3, SOOKE DISTRICT,
PLAN VIP86360.

SHEET 1 OF 4 SHEETS
STRATA PLAN EPS1258

Capital Regional Assessment Area
BCGS 92B.032

The intended plot size of this plan is 432mm
in width by 280mm in height (B Size) when
plotted at a scale of 1:200.

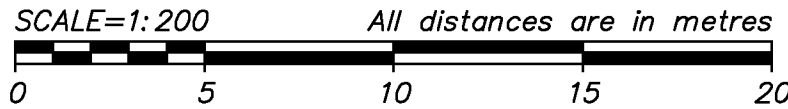

LEGEND
Astronomic bearings were derived from Plan VIP86360.

- Denotes standard iron post found.

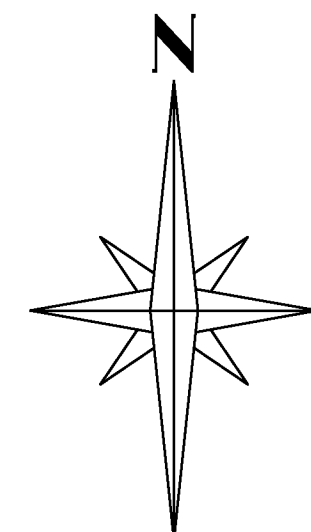
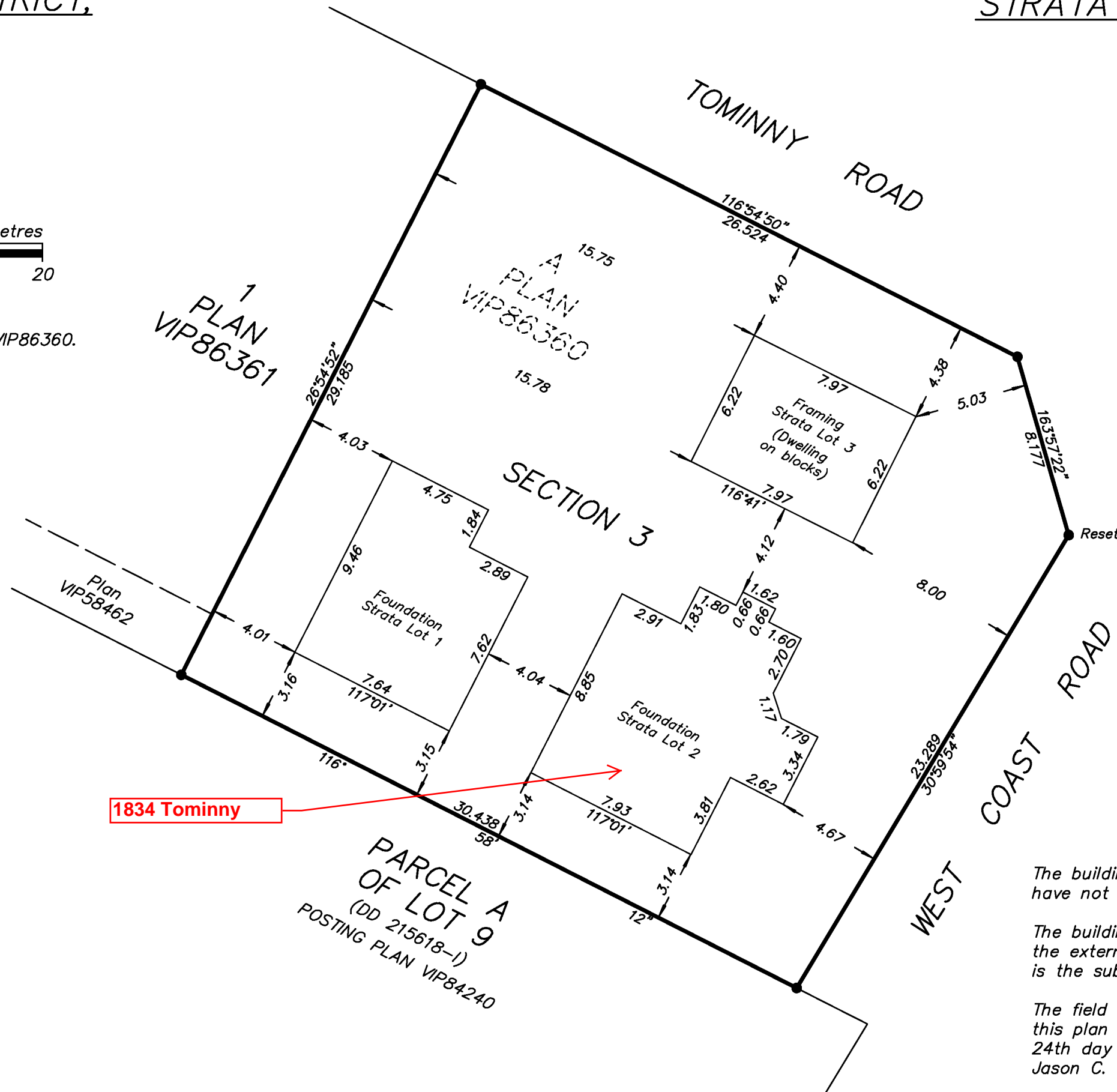

The addresses of the project
are not known at this time.

This plan lies within the District of Sooke
and the Capital Regional District.

File: 0613-JK-W170
Archive: W170-JB-ST1
Island Land Surveying Ltd.
1-15 Cadillac Avenue
Victoria, B.C. V8Z 1T3
Tel 250.475.1515 Fax 250.475.1516
www.islandsurveying.ca

The buildings in this strata plan
have not been previously occupied.

The buildings shown hereon are within
the external boundaries of the land that
is the subject of the strata plan.

The field survey represented by
this plan was completed on the
24th day of January, 2013.
Jason C. Kozina, BCLS

FIRST LEVEL

SHEET 2 OF 4 SHEETS STRATA PLAN EPS1258

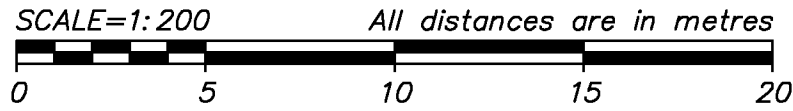

The intended plot size of this plan is 432mm in width by 280mm in height (B Size) when plotted at a scale of 1:200.

LEGEND
 SL Denotes "Strata Lot _"
 LCP Denotes "Limited Common Property, limited for the use of Strata Lot _"

All patios and balconies are defined as to height by the centre of the floor above or its extensions, or where there is no floor above, by the average height of a strata lot within the same building, unless otherwise indicated.

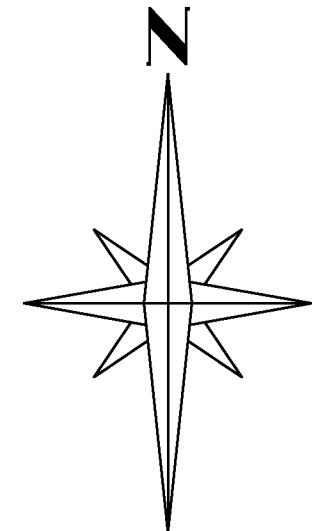
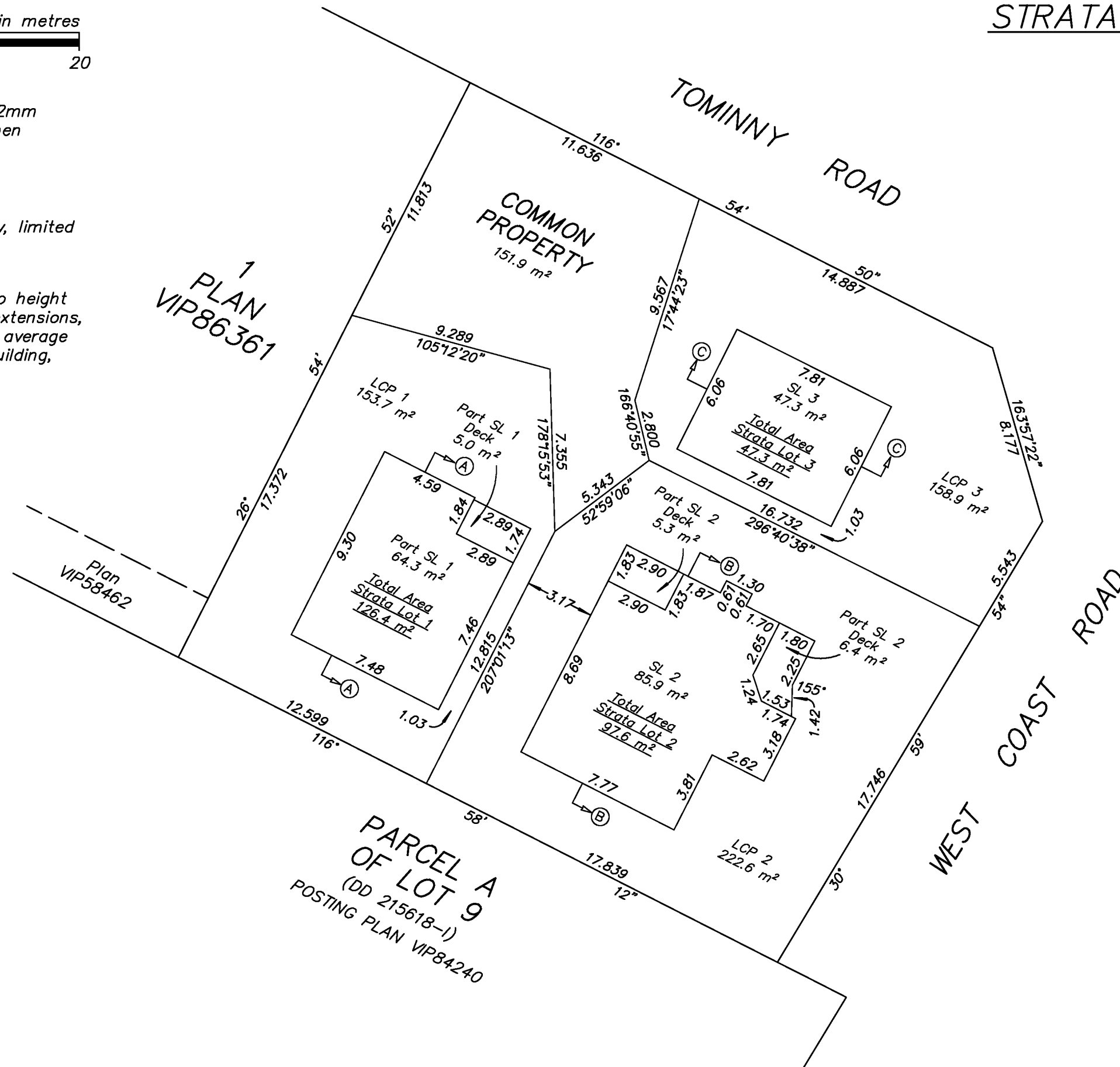

File: 0613-JK-W170
 Archive: W170-JB-ST2
Island Land Surveying Ltd.
 1-15 Cadillac Avenue
 Victoria, B.C. V8Z 1T3
 Tel 250.475.1515 Fax 250.475.1516
 www.islandsurveying.ca

Jason C. Kozina, BCLS
 January 24, 2013

SECOND LEVEL

SHEET 3 OF 4 SHEETS STRATA PLAN EPS1258

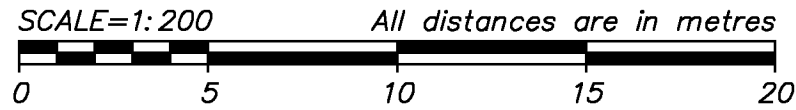

The intended plot size of this plan is 432mm in width by 280mm in height (B Size) when plotted at a scale of 1:200.

LEGEND

SL Denotes "Strata Lot _"
LCP Denotes "Limited Common Property, limited for the use of Strata Lot _"

All patios and balconies are defined as to height by the centre of the floor above or its extensions, or where there is no floor above, by the average height of a strata lot within the same building, unless otherwise indicated.

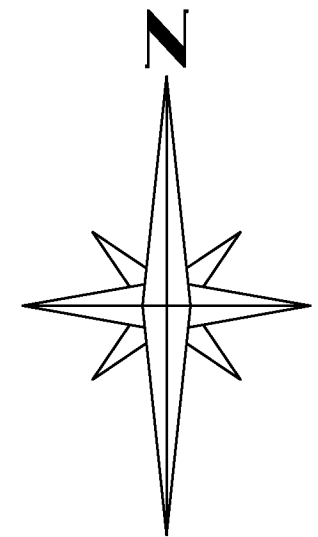
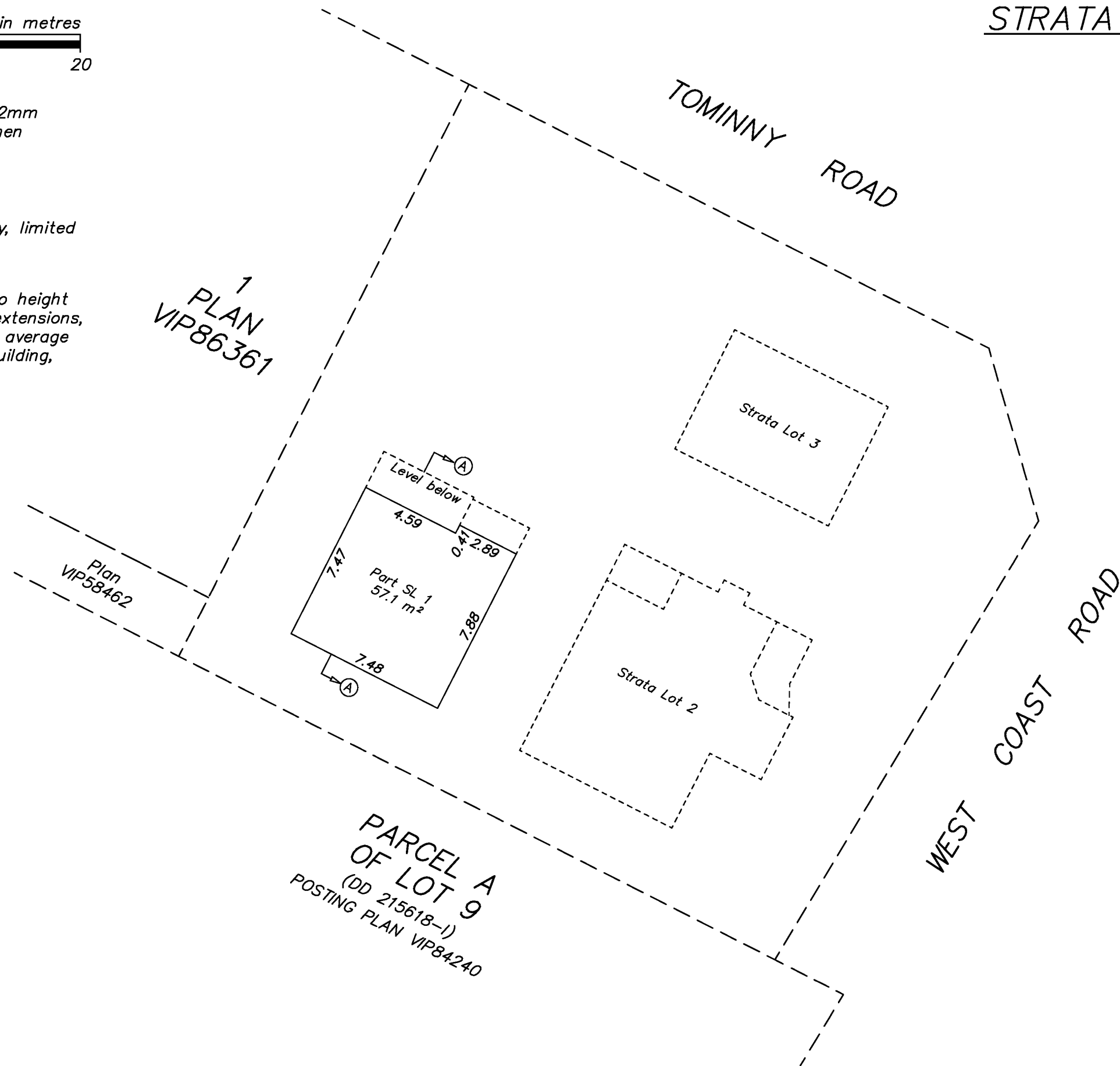

File: 0613-JK-W170
Archive: W170-JB-ST3
Island Land Surveying Ltd.
1-15 Cadillac Avenue
Victoria, B.C. V8Z 1T3
Tel 250.475.1515 Fax 250.475.1516
www.islandsurveying.ca

PARCEL A
OF LOT 9
(DD 215618-1)
POSTING PLAN VIP84240

Jason C. Kozina, BCLS
January 24, 2013

SECTIONS

SHEET 4 OF 4 SHEETS
STRATA PLAN EPS1258

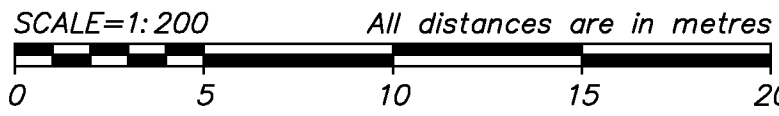

The intended plot size of this plan is 432mm in width by 280mm in height (B Size) when plotted at a scale of 1:200.

LEGEND
SL Denotes "Strata Lot _"

SECTION A-A

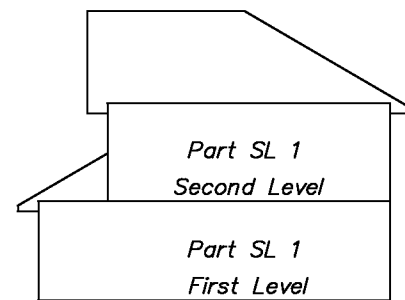

SECTION B-B

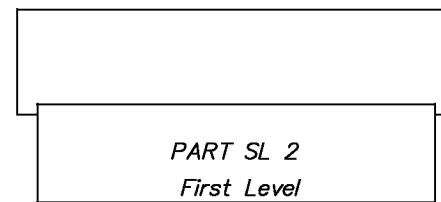

SECTION C-C

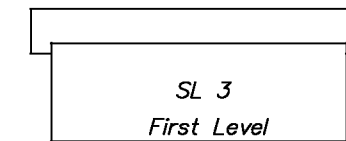

File: 0613-JK-W170
 Archive: W170-JB-ST4
Island Land Surveying Ltd.
 1-15 Cadillac Avenue
 Victoria, B.C. V8Z 1T3
 Tel 250.475.1515 Fax 250.475.1516
 www.islandsurveying.ca

Jason C. Kozina, BCLS
January 24, 2013