

**4235 Mount Seymour Parkway,
North Vancouver, B.C.**

Totals**

Main Level: 652 sq. ft.
 Upper Level: 606 sq. ft.
 Lower Level: 446 sq. ft.
 Total: 1,704 sq. ft.
 Utility Room: 184 sq. ft.
 Grand Total: 1,888 sq. ft.

Porch: 19 sq. ft.
 Patio: 436 sq. ft.
 Lower Entry: 15 sq. ft.
 Total: 470 sq. ft.

** Approx. based on interior measurements to exterior walls
 ** Total square footage not taken from original blueprints
 ** Total square footage includes under-height and unfinished areas

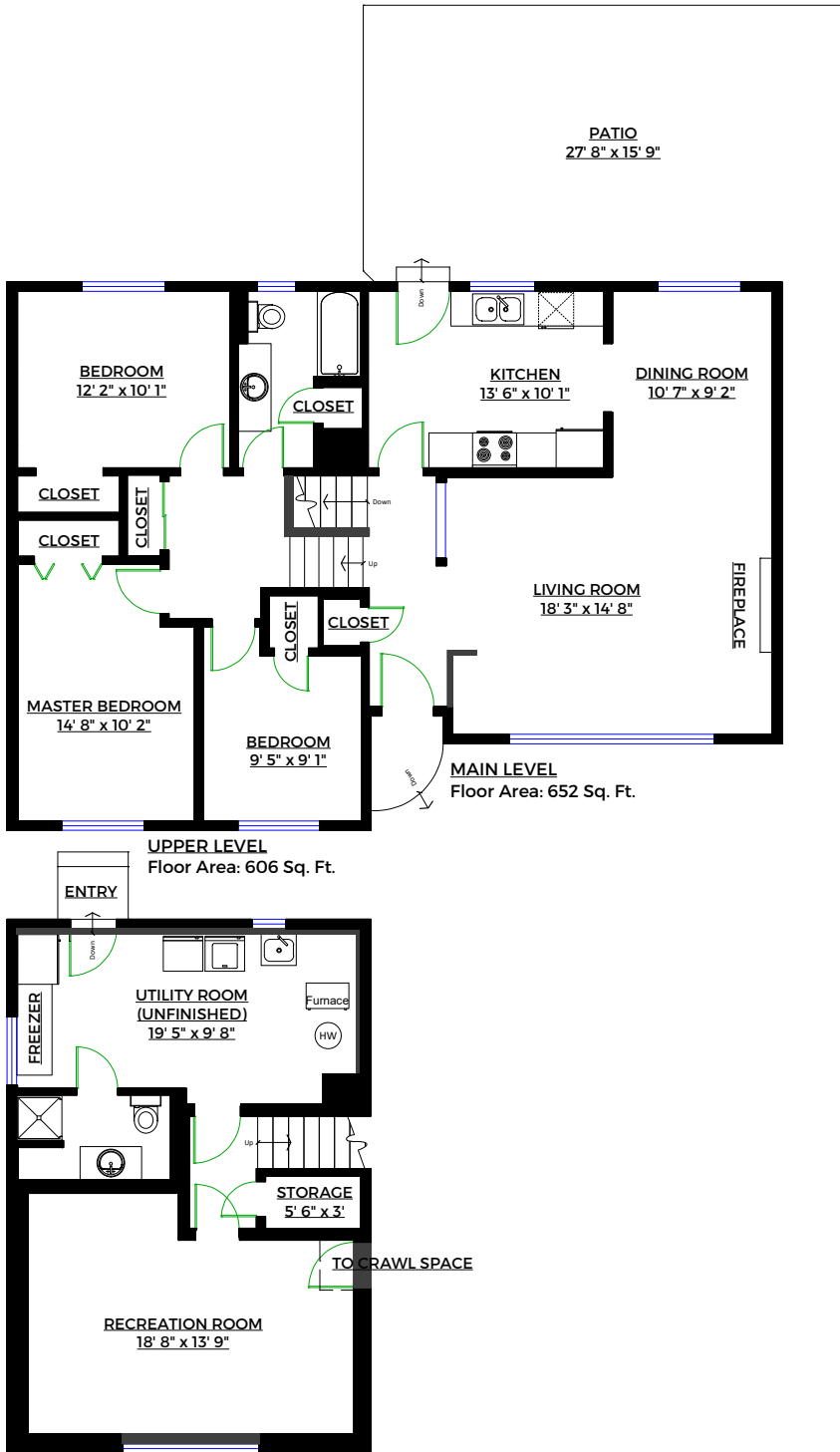
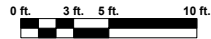

PRESTIGE REALTY

Patricia Houlihan
604-376-7653