

STRATA PLAN OF LOT 4  
BLOCK X DISTRICT LOT 51  
PLAN LMP 5831

STRATA PLAN LMS 1558

B.C.G.S. 92G.025

DEPOSITED AND REGISTERED IN THE LAND TITLE  
OFFICE AT NEW WESTMINSTER, B.C.  
THIS 23 DAY OF AUG, 1994.

SCALE 1 : 500

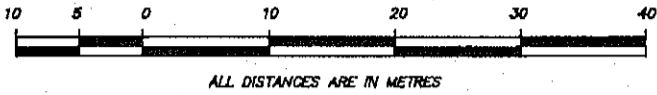

*[Signature]*  
ASSISTANT REGISTRAR  
DEPUTY

CITY OF VANCOUVER

INTEGRATED AREA No. 31 VANCOUVER

THIS PLAN SHOWS GROUND LEVEL MEASURED DISTANCES.  
PRIOR TO COMPUTATION OF U.T.M. COORDINATES MULTIPLY  
BY COMBINED FACTOR OF 0.9995899737

THIS PLAN LIES WITHIN  
THE GREATER VANCOUVER  
REGIONAL DISTRICT

BEARINGS ARE GRID BEARINGS DERIVED FROM  
MONUMENTS V2065 AND V2714



V 2065

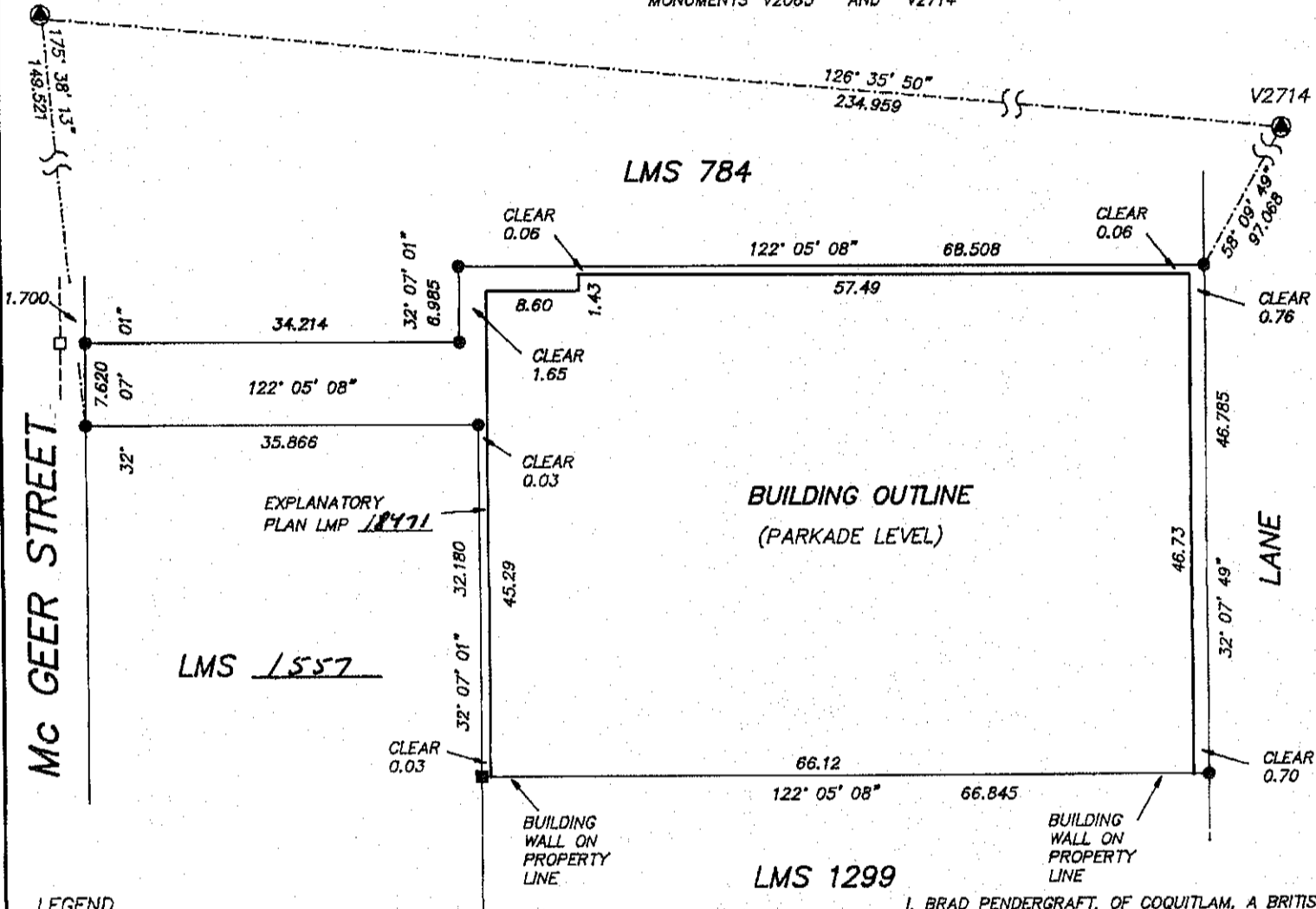

LEGEND

- L.C.P. DENOTES LIMITED COMMON PROPERTY
- ⊙ DENOTES COMMON PROPERTY
- ⊕ DENOTES ELEVATOR
- S.L. DENOTES STRATA LOT
- m<sup>2</sup> DENOTES SQUARE METRES
- sqft DENOTES SQUARE FEET
- ⊖ DENOTES DECK, L.C.P. APPURTENANT TO ADJACENT STRATA LOT
- ⊗ DENOTES PATIO, L.C.P. APPURTENANT TO ADJACENT STRATA LOT
- ⊙ DENOTES BALCONY, L.C.P. APPURTENANT TO ADJACENT STRATA LOT
- ⊙ DENOTES CONTROL MONUMENT FOUND
- DENOTES STANDARD IRON POST FOUND
- DENOTES OLD LEAD PLUG FOUND
- DENOTES LEAD PLUG SET
- WT DENOTES WITNESS

NOTE:

ALL PARKING STALLS AND STORAGE  
LOCKERS SHOWN ON SHEETS 6-9, AND  
SHEETS 24-26 ARE COMMON PROPERTY.  
ALL AREAS LABELED EITHER VENT, TEL,  
ELEC, OR ROOF ON SHEETS 10-23 ARE  
COMMON PROPERTY.

*For Strata Corp Mail Address  
See Strata Pl. General Index.*

THE ADDRESS FOR SERVICE OF DOCUMENTS  
ON THE STRATA CORPORATION IS :  
THE OWNERS, STRATA PLAN LMS 1558  
9th FLOOR 1190 HORNBY STREET,  
VANCOUVER, B.C. V6Z 2K5

CIVIC ADDRESS OF PROPERTY:  
3489 ASCOT PLACE,  
VANCOUVER, B.C.

I, BRAD PENDERGRAFT, OF COQUITLAM, A BRITISH  
COLUMBIA LAND SURVEYOR, HEREBY CERTIFY  
THAT THE BUILDING ERECTED ON THE  
PARCEL DESCRIBED ABOVE IS WHOLLY  
WITHIN THE EXTERNAL BOUNDARIES OF THAT  
PARCEL.  
DATED THIS 26th DAY OF JULY, 1994

*[Signature]*  
B.C.L.S.

I, BRAD PENDERGRAFT, OF COQUITLAM, A BRITISH  
COLUMBIA LAND SURVEYOR, HEREBY CERTIFY  
THAT THE BUILDING SHOWN IN THIS STRATA  
PLAN HAS NOT AS OF THE 26th DAY OF  
JULY, 1994 BEEN PREVIOUSLY  
OCCUPIED.  
DATED THIS 26th DAY OF JULY, 1994

*[Signature]*  
B.C.L.S.

SOLOP LAND SURVEYING INC.  
201 - 8484 162nd STREET  
SURREY, B.C. V4N 1B4  
TEL 597 6161 FAX 597 0259  
FILE: 2608H1

CONDOMINIUM ACT

STRATA PLAN LMS 1558

LOT NO.	SHEET NO.	FORM 1	FORM 2	FORM 3
		SCHEDULE OF UNIT ENTITLEMENT	SCHEDULE OF INTEREST UPON DESTRUCTION	SCHEDULE OF VOTING RIGHTS
		UNIT ENTITLEMENT (AREA)	INTEREST UPON DESTRUCTION	NUMBER OF VOTES
1	10	741	749850	1
2	10	487	562388	1
3	10	625	659868	1
4	10	708	747351	1
5	10	621	657369	1
6	10	498	544891	1
7	10	498	544891	1
8	10	498	544891	1
9	10	735	739852	1
10	11	757	762348	1
11	11	480	569886	1
12	11	625	682364	1
13	11	546	637373	1
14	11	708	759848	1
15	11	621	667367	1
16	11	498	557389	1
17	11	498	557389	1
18	11	498	557389	1
19	11	743	752350	1
20	11	718	717357	1
21	12	757	774845	1
22	12	480	577385	1
23	12	625	689862	1
24	12	546	644871	1
25	12	708	772346	1
26	12	621	677365	1
27	12	498	569886	1
28	12	498	569886	1
29	12	498	569886	1
30	12	743	764847	1
31	12	718	727355	1
32	13	757	787343	1
33	13	480	584883	1
34	13	625	699860	1
35	13	546	652370	1
36	13	708	784843	1
37	13	621	687363	1
38	13	498	577385	1
39	13	498	577385	1
40	13	498	577385	1
41	13	743	777345	1
42	13	718	737353	1
43	14	711	752350	1
44	14	480	592382	1
45	14	625	712358	1
46	14	546	662368	1
47	14	708	799840	1
48	14	621	699860	1
49	14	498	587383	1
50	14	498	587383	1
51	14	498	587383	1
52	14	697	737353	1
53	14	718	747351	1
54	15	711	767347	1
55	15	480	609878	1
56	15	625	724855	1
57	15	546	672366	1
58	15	708	814837	1
59	15	621	712358	1
60	15	498	597381	1
61	15	498	597381	1

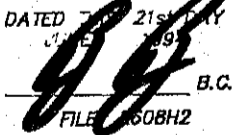
DATED 21st DAY OF  
  
 B.C.L.S.  
 FILE 1608H2

FILED LMS1558 691841 2001-09-10-08:47:13.793827

CONDOMINIUM ACT

STRATA PLAN LMS 1558

LOT NO.	SHEET NO.	FORM 1	FORM 2	FORM 3
		SCHEDULE OF UNIT ENTITLEMENT	SCHEDULE OF INTEREST UPON DESTRUCTION	SCHEDULE OF VOTING RIGHTS
		UNIT ENTITLEMENT (AREA)	INTEREST UPON DESTRUCTION	NUMBER OF VOTES
62	15	498	597381	1
63	15	697	752350	1
64	15	718	759848	1
65	16	711	782344	1
66	16	480	619876	1
67	16	625	737353	1
68	16	546	682364	1
69	16	708	832334	1
70	16	621	727355	1
71	16	498	607379	1
72	16	498	607379	1
73	16	498	607379	1
74	16	697	767347	1
75	16	718	772346	1
76	17	711	797341	1
77	17	480	629874	1
78	17	625	749850	1
79	17	546	692362	1
80	17	708	849830	1
81	17	621	742352	1
82	17	498	617377	1
83	17	498	617377	1
84	17	498	617377	1
85	17	697	782344	1
86	17	718	784843	1
87	18	711	812338	1
88	18	480	639872	1
89	18	625	762348	1
90	18	546	702360	1
91	18	708	867327	1
92	18	621	757349	1
93	18	498	627375	1
94	18	498	627375	1
95	18	498	627375	1
96	18	697	797341	1
97	18	718	797341	1
98	19	711	827335	1
99	19	480	649870	1
100	19	625	774845	1
101	19	546	712358	1
102	19	708	884823	1
103	19	621	772346	1
104	19	498	637373	1
105	19	498	637373	1
106	19	498	637373	1
107	19	697	812338	1
108	19	718	809838	1
109	20	711	842332	1
110	20	480	659868	1
111	20	625	787343	1
112	20	546	722356	1
113	20	708	902320	1
114	20	621	787343	1
115	20	498	647371	1
116	20	498	647371	1
117	20	498	647371	1
118	20	697	827335	1
119	20	718	822336	1
120	21	711	859828	1
121	21	480	674865	1
122	21	625	802340	1

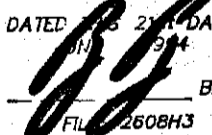
DATED 25 DAY OF SEP 1994  
  
 B.C.L.S.  
 FILE # 2608H3

FILED LMS1558 691841 2001-09-10-08.47.13.793827

CONDOMINIUM ACT

STRATA PLAN LMS 1558

LOT NO.	SHEET NO.	FORM 1	FORM 2	FORM 3
		SCHEDULE OF UNIT ENTITLEMENT	SCHEDULE OF INTEREST UPON DESTRUCTION	SCHEDULE OF VOTING RIGHTS
		UNIT ENTITLEMENT (AREA)	INTEREST UPON DESTRUCTION	NUMBER OF VOTES
123	21	744	974805	1
124	21	720	924815	1
125	21	498	659868	1
126	21	498	659868	1
127	21	697	844831	1
128	21	651	822336	1
129	22	558	747351	1
130	22	480	689862	1
131	22	835	1069796	1
132	22	713	899820	1
133	22	498	672366	1
134	22	548	732354	1
135	22	651	822336	1
136	23	551	759848	1
137	23	743	964807	1
138	23	711	917317	1
139	23	548	744851	1
140	23	651	837333	1
AGGREGATE		84778	100000042	140

FILED LMS1558 691841 2001-09-10-08:47:13.793827

**STATUTORY DECLARATION**

I / ~~WE~~ THE UNDERSIGNED DO SOLEMNLY DECLARE THAT  
 [1] I / ~~WE~~ THE UNDERSIGNED AM / ARE THE OWNER - DEVELOPER OR ( IN THE ALTERNATE )  
 THE DULY AUTHORIZED AGENT OF THE OWNER - DEVELOPER.  
 [2] THE STRATA PLAN IS ENTIRELY FOR RESIDENTIAL USE.  
 I / ~~WE~~ MAKE THIS SOLEMN DECLARATION CONSCIENTIOUSLY BELIEVING IT TO BE TRUE AND  
 KNOWING THAT IT IS OF THE SAME FORCE AND EFFECT AS IF MADE UNDER OATH.

DECLARED BEFORE ME AT Vancouver

IN THE PROVINCE OF BRITISH COLUMBIA  
 THIS 11 DAY OF August, 1994

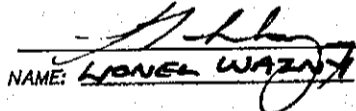
  
 NAME: LIONEL WAZNY

  
 A COMMISSIONER FOR TAKING AFFIDAVITS  
 WITHIN THE PROVINCE OF BRITISH COLUMBIA  
J GARRY WATSON  
 ACCEPTED AS TO FORMS 1,2 AND 3  
 DATED THIS 18 DAY OF Aug, 1994.

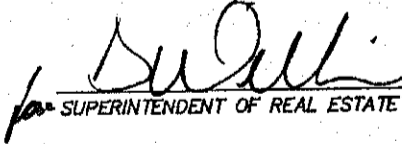
  
 SUPERINTENDENT OF REAL ESTATE

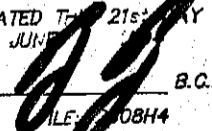
DATED THE 21st DAY OF  
JUNE  
  
 B.C.L.S.  
 FILE # 008H4

CONDOMINIUM ACT

STRATA PLAN LMS 1558

FILED LMS1558 691841 2001-09-10-08.47.13.793827

OWNER

380883 B.C. LTD.  
(INCORPORATION NO. 380883)  
37 1/2 AUTHORIZED SIGNATORY

  
NAME: DAVID R. PODMORE

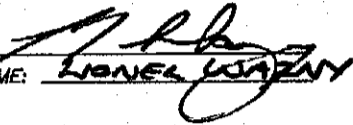
  
NAME: LIONEL WAZNY

MORTGAGEE:

LAURENTIAN BANK OF CANADA  
37 1/2 AUTHORIZED SIGNATORY

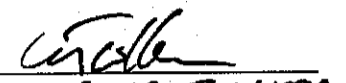
  
NAME: GEOFF TALLARD

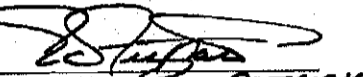
  
NAME: ED FITZPATRICK

WITNESS

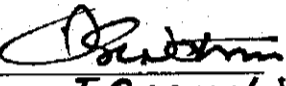
  
NAME: J. GARRY WATSON  
2317 BOULDER RIDGE  
WHISTLER, B.C.  
ADDRESS OF WITNESS

LAWYER  
OCCUPATION OF WITNESS

WITNESS

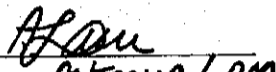
  
NAME: ANTONIA LAM  
825 W. PENDER ST., VANCOUVER, B.C.  
ADDRESS OF WITNESS

ADMINISTRATOR  
OCCUPATION OF WITNESS

LESSEE

431691 BRITISH COLUMBIA LTD.  
(INCORPORATION NO. 431691)  
37 1/2 AUTHORIZED SIGNATORY

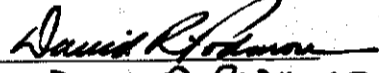
  
NAME: DAVID R. PODMORE

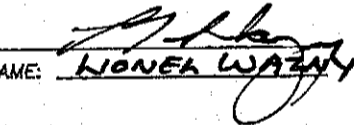
  
NAME: LIONEL WAZNY

WITNESS

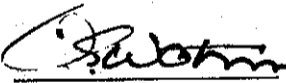
  
NAME: J. GARRY WATSON  
2317 BOULDER RIDGE  
WHISTLER, B.C.  
ADDRESS OF WITNESS

LAWYER  
OCCUPATION OF WITNESS

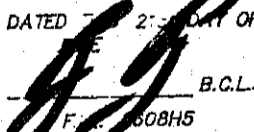
DATED 21 DAY OF SEP  
  
B.C.L.S.  
F. 608H5

# PARKING LEVEL P1 (WEST) FLOOR PLAN

STRATA PLAN LMS 1558

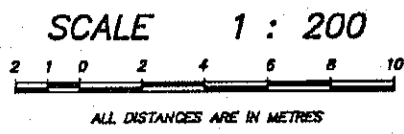

MATCHLINE

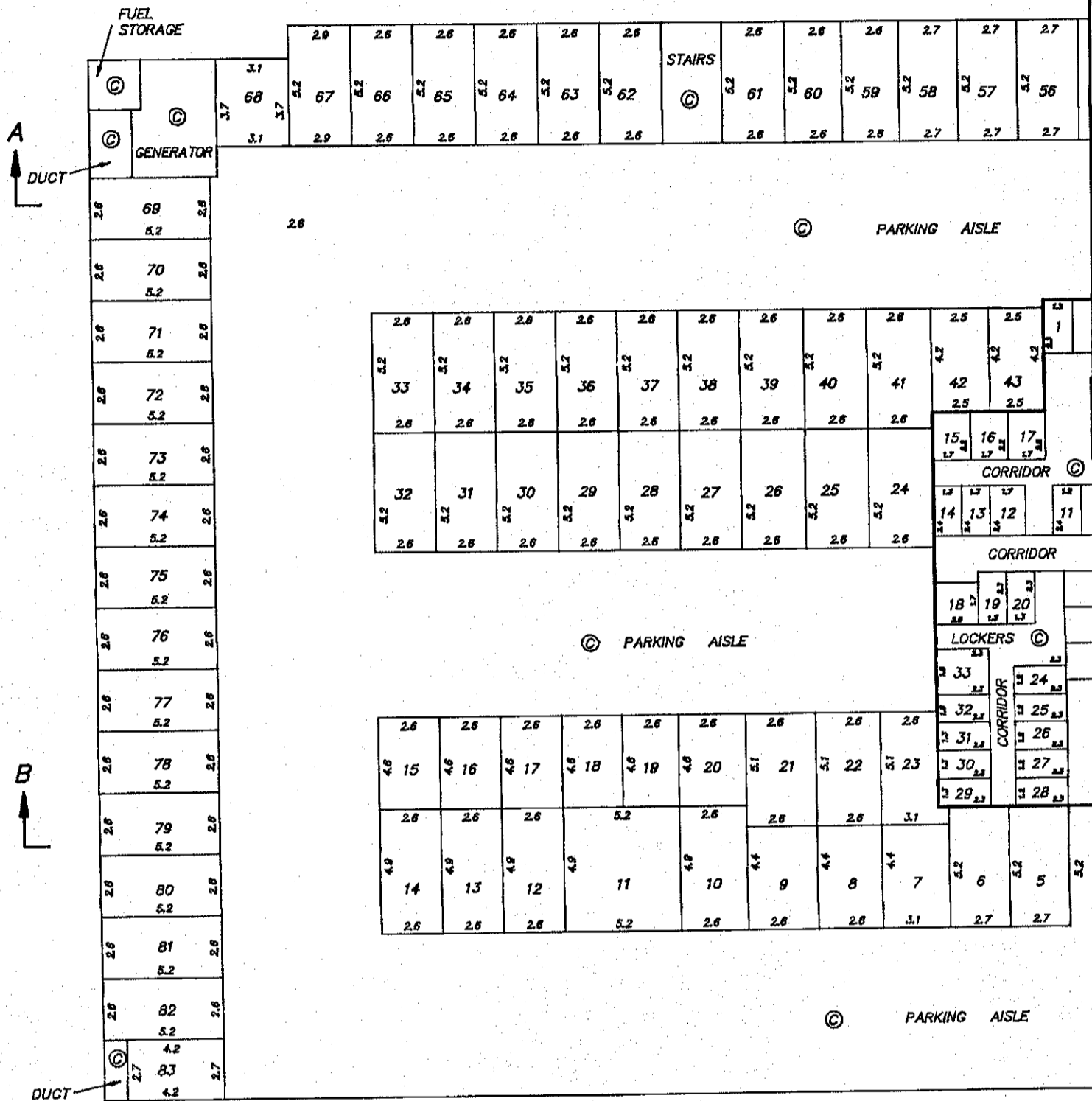

MATCHLINE

DATED 27 JULY 2001 DAY OF JULY

*[Signature]*

B.C.L.S.

FILE: 2888H6

# PARKING LEVEL P1 (EAST) FLOOR PLAN

STRATA PLAN LMS 1558

SCALE 1 : 200



ALL DISTANCES ARE IN METRES



MATCHLINE

C' ←

A' ↑

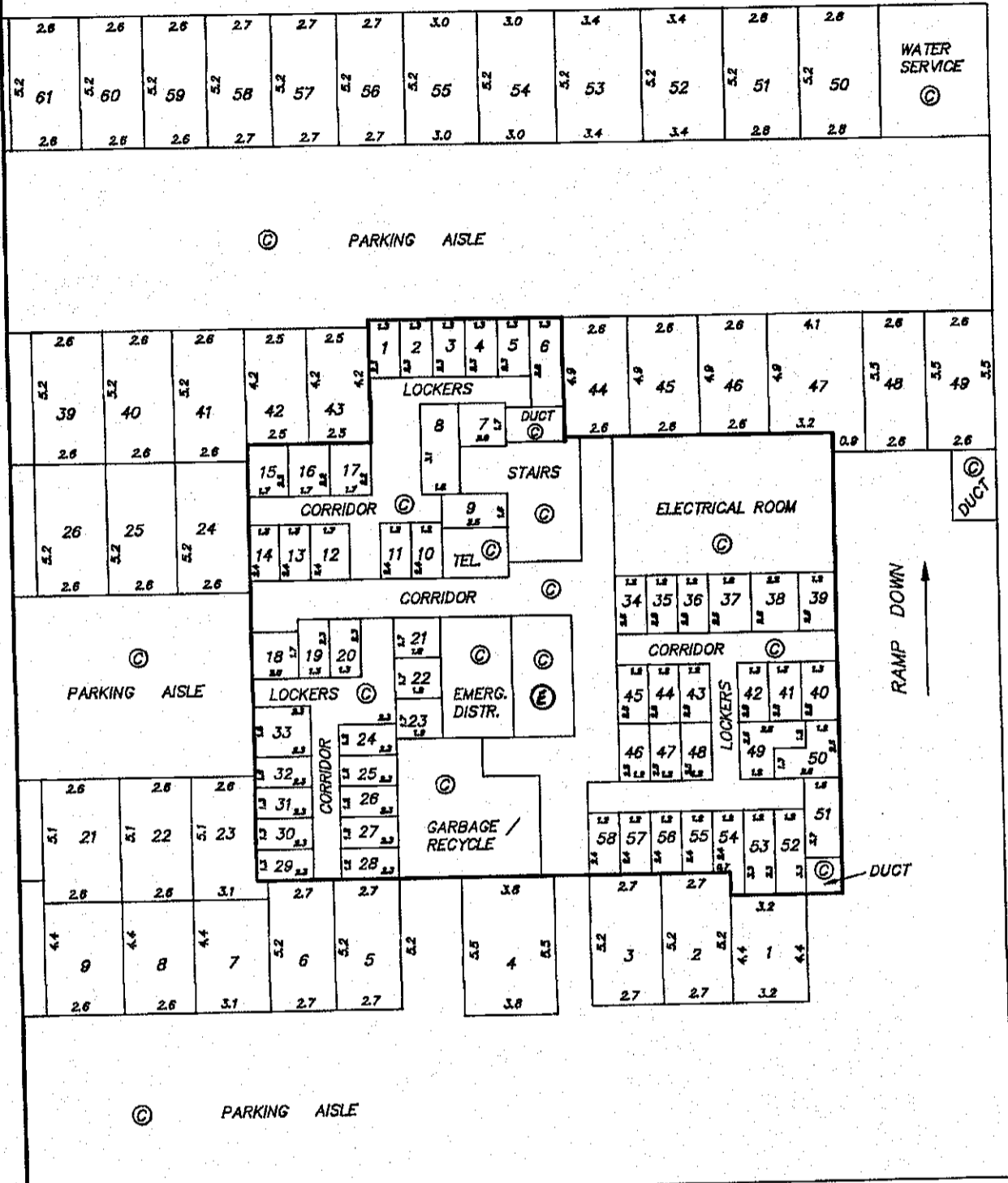

MATCHLINE

C ←

B' ↑

DATED 21st OF  
 JUN 2001  
 B.C.L.S.  
 FILE: 1558/7

# PARKING LEVEL P2 (WEST) FLOOR PLAN

STRATA PLAN LMS 1558

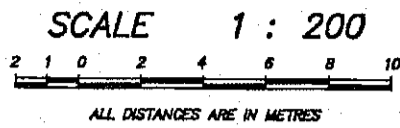

MATCHLINE

A  
DUCT

B  
DUCT

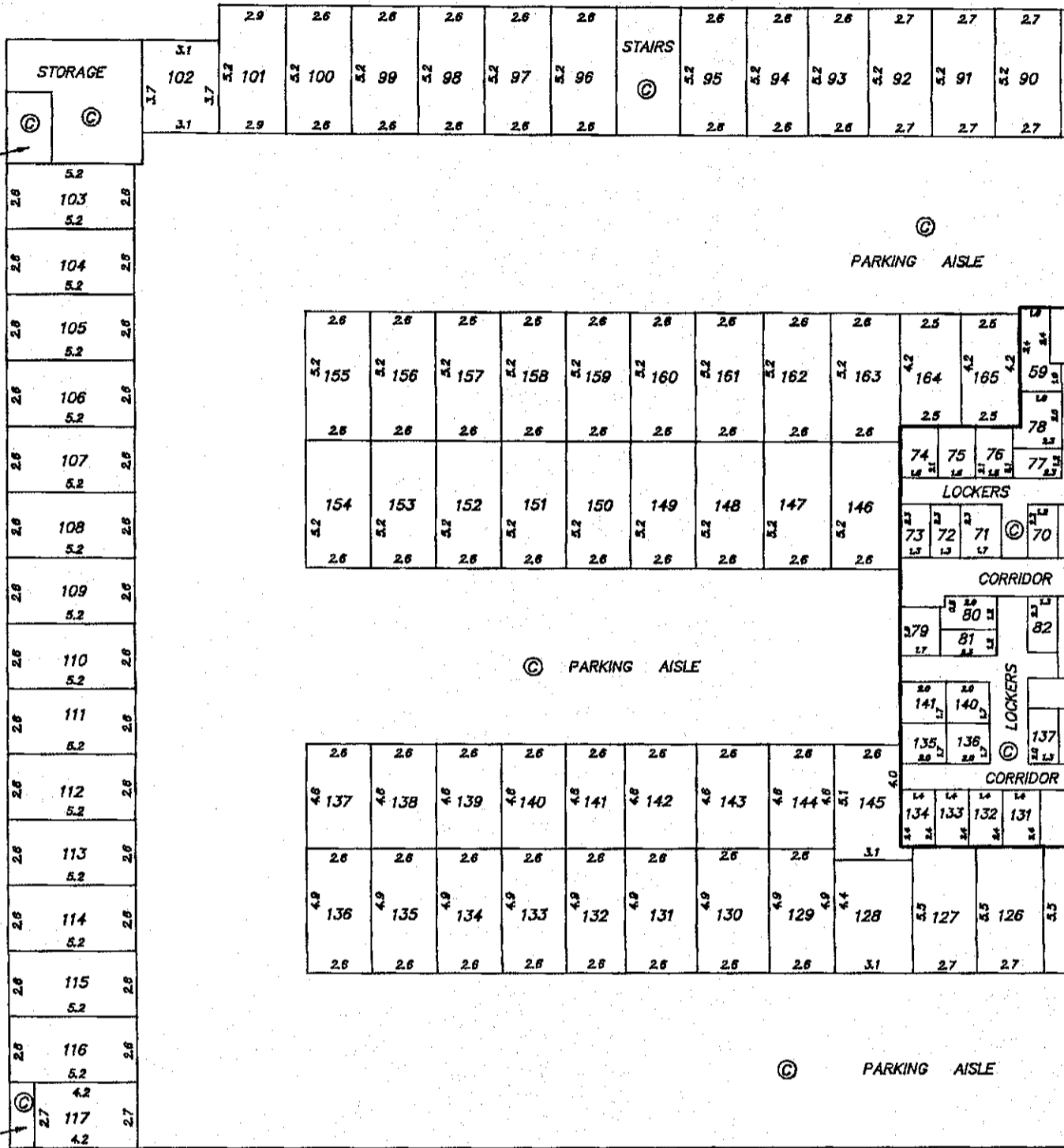

MATCHLINE

DATED 21st DAY OF  
 1958  
 B.C.L.S.  
 P.L.E. S.B.H.B.



# PARKING LEVEL P2 (EAST) FLOOR PLAN

STRATA PLAN LMS 1558

SCALE 1 : 200



ALL DISTANCES ARE IN METRES



MATCHLINE

C' ←

A' ↑

B' ↑

C ←

MATCHLINE

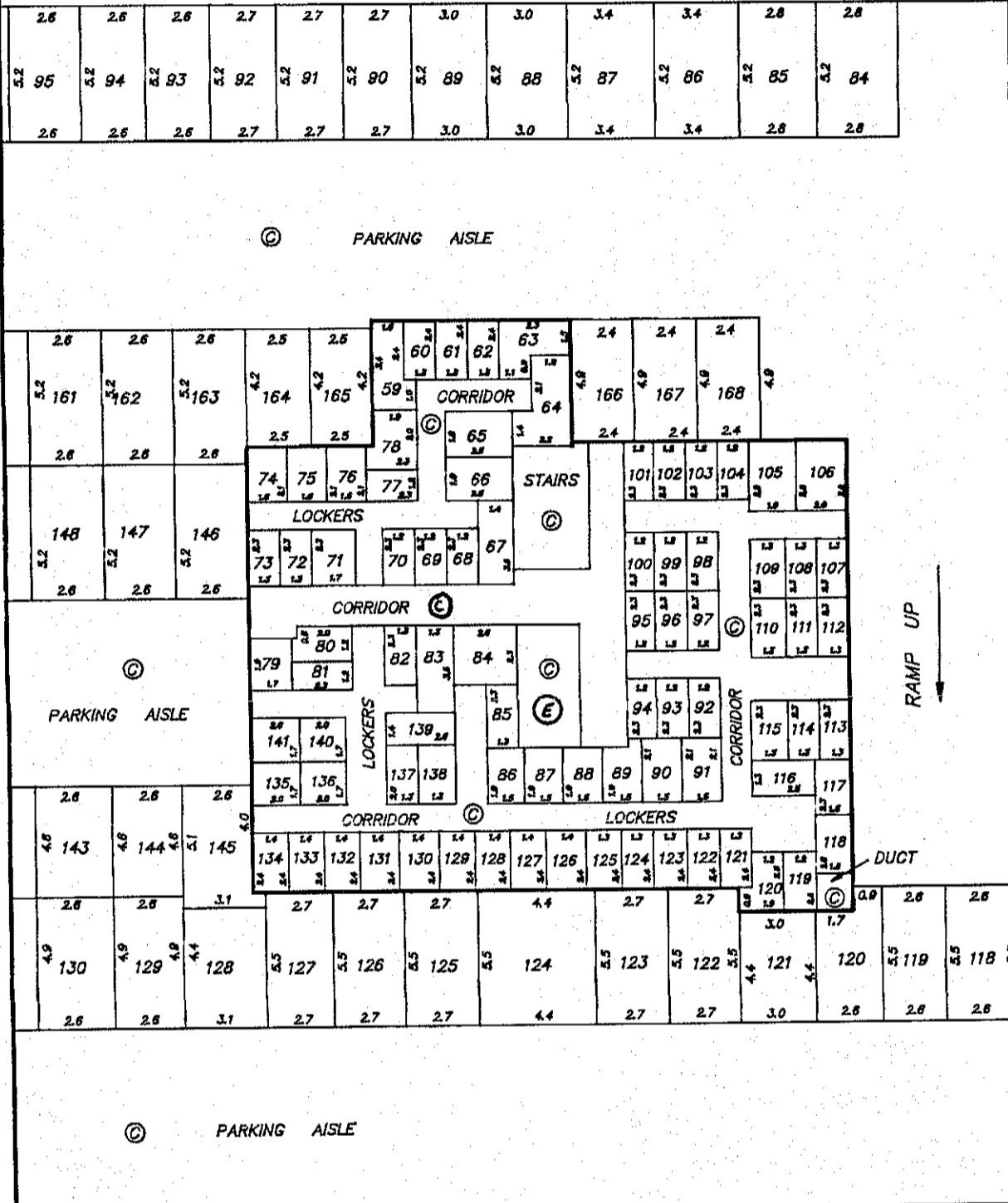

RAMP UP

DUCT

DATED 7<sup>th</sup> 21<sup>st</sup> DAY OF  
 J. 2004  
 B.C.L.S.  
 FILE: 008H9

GROUND FLOOR PLAN

STRATA PLAN LMS 1558

SCALE 1 : 200



ALL DISTANCES ARE IN METRES

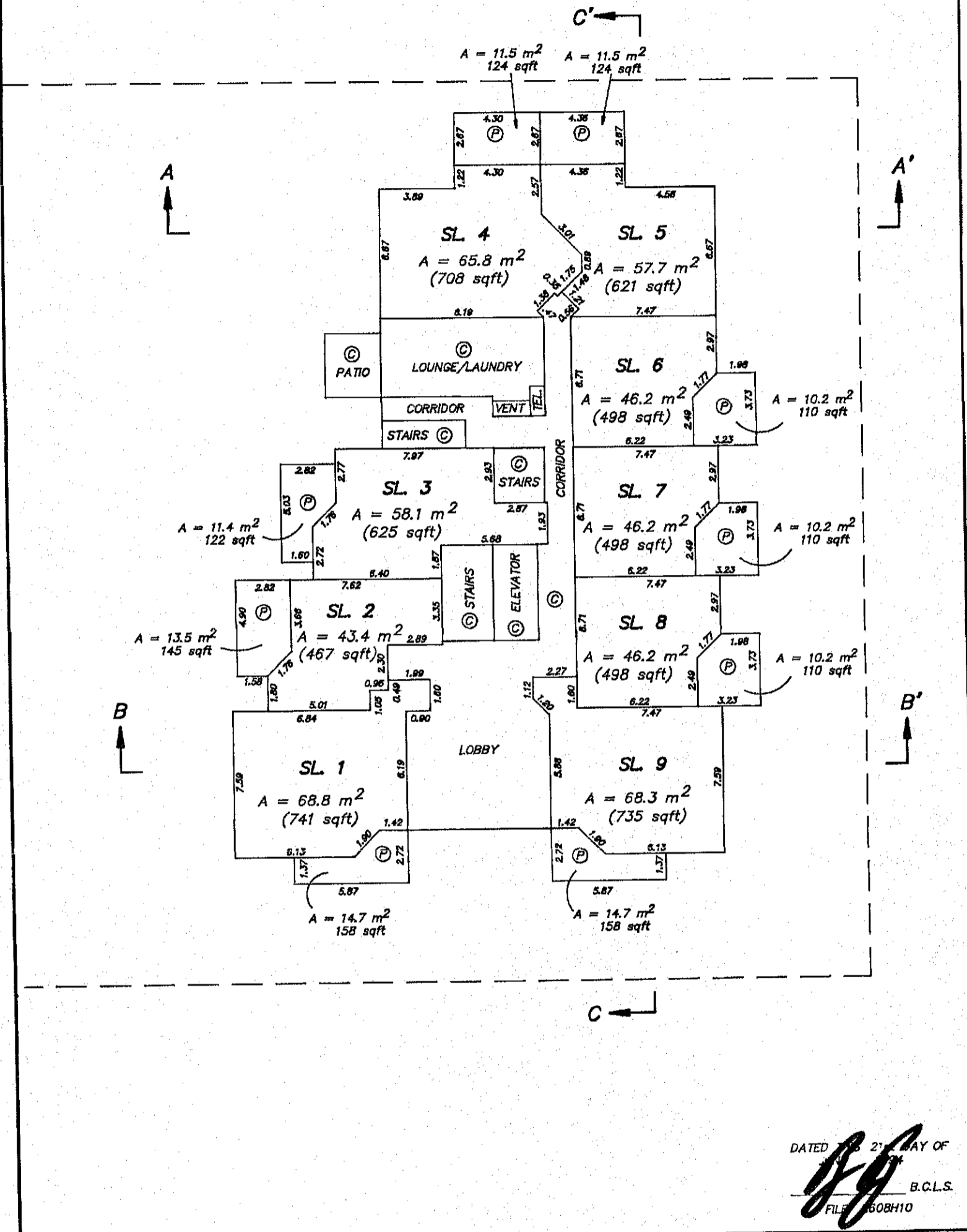

FILED LMLMS1558 691841 2001-09-10-08.47.13.793827

DATED 21 MAY OF  
B.C.L.S.  
FILE 60BH10

SECOND FLOOR PLAN

STRATA PLAN LMS 155B

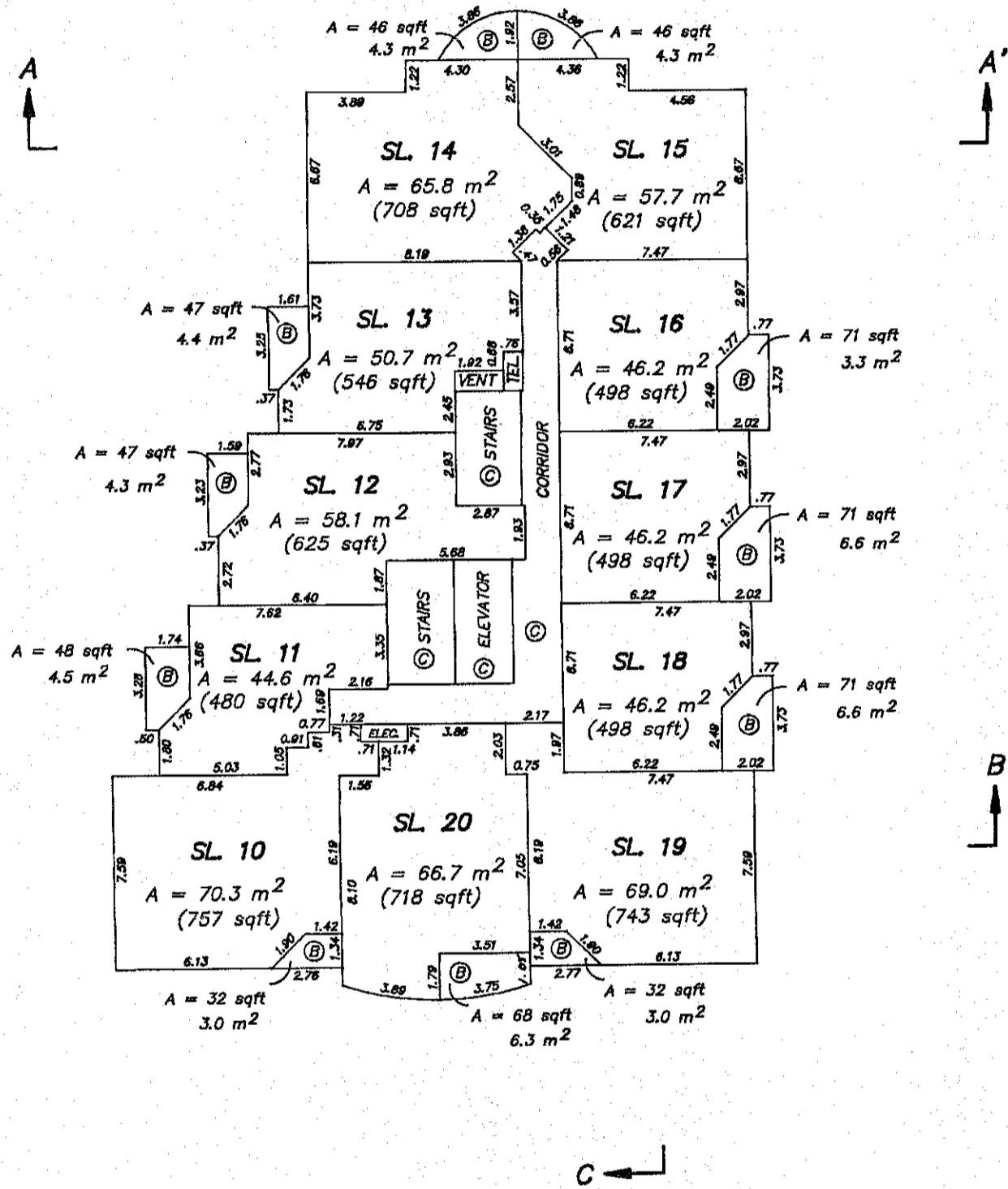
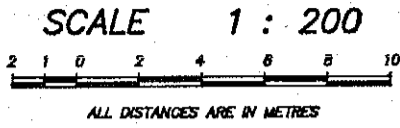

FILED LMS1558 691841 2001-09-10-08:47:13.793822

DATED THIS 21 OF  
 JUN 2001  
 B.C.L.S.  
 E: 155B11

THIRD FLOOR PLAN

STRATA PLAN LMS 1558

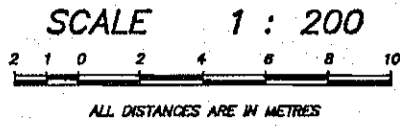

C' ←

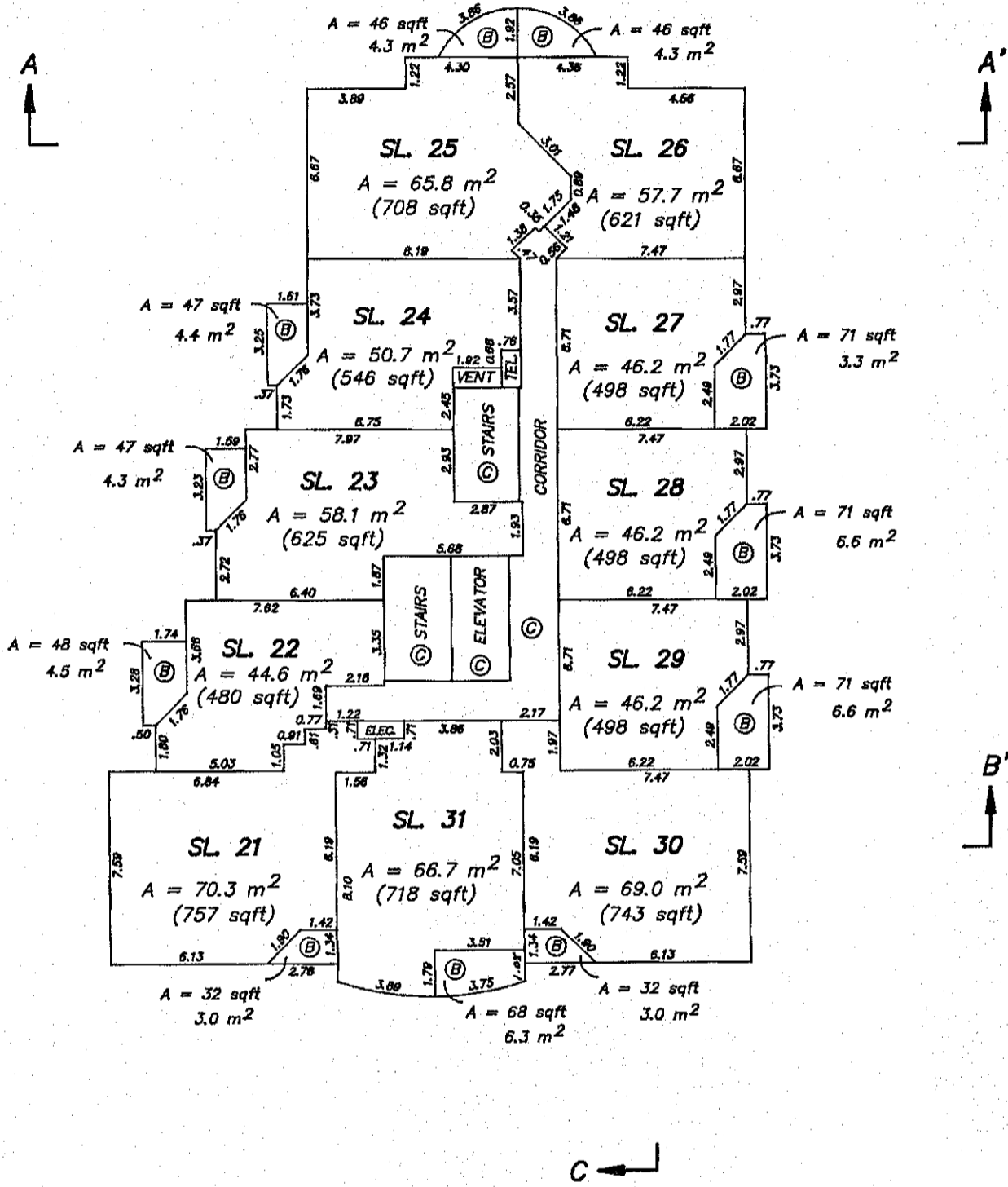

C ←

DATED 21 MAY OF  
 JUNE  
 B.C.L.S.  
 FILE 1008H12

FOURTH FLOOR PLAN

STRATA PLAN LMS 1558

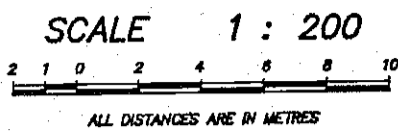

C' ←

A ↑

A' ↑

B ↑

B' ↑

C ←

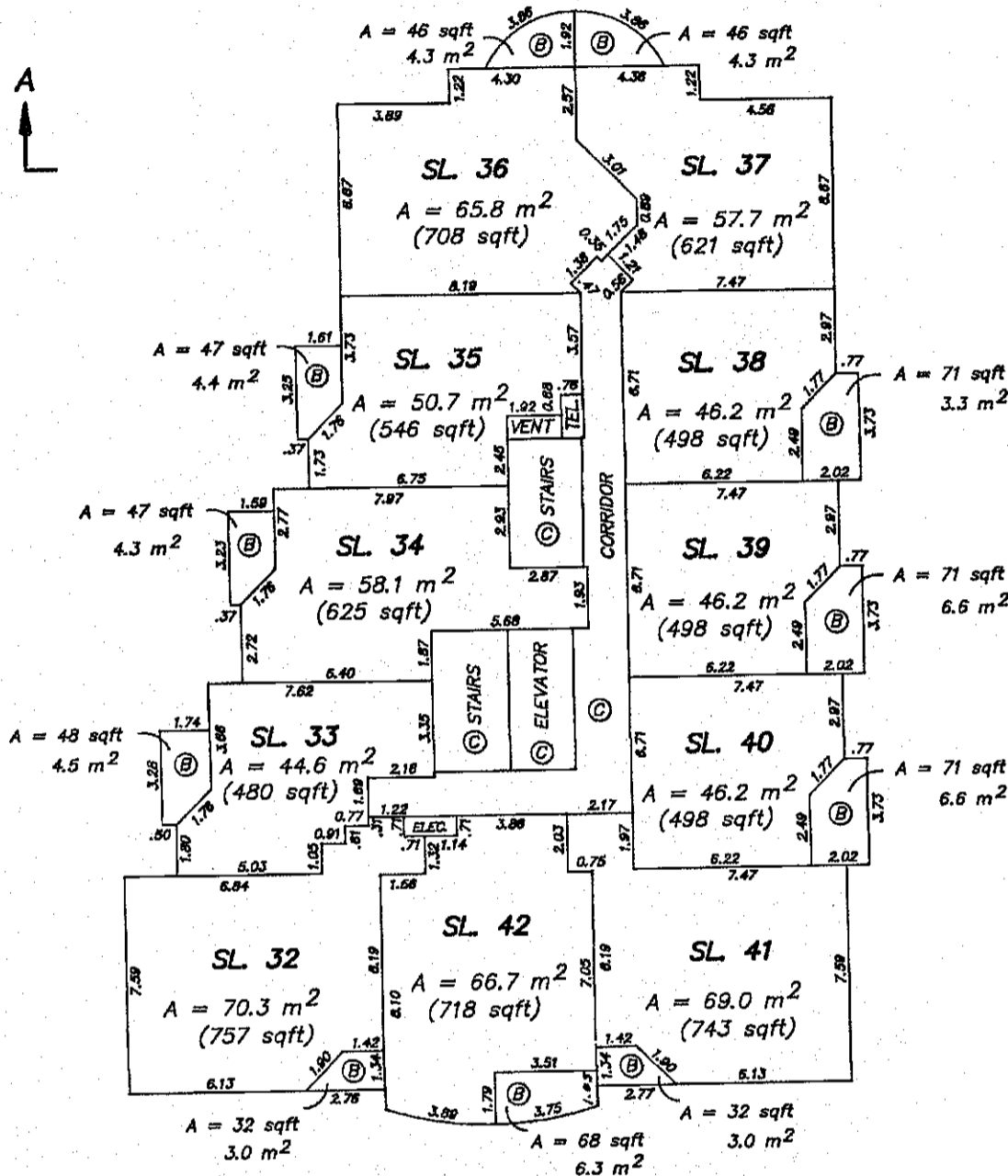

DATED THIS 21<sup>ST</sup> DAY OF  
 JULY  
 B.C.L.S.  
 FILE NO. 08H13

FIFTH FLOOR PLAN

STRATA PLAN LMS 1558

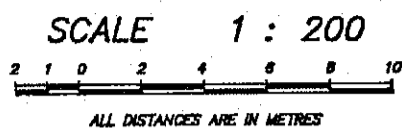

C' ←

A ↑

A' ↑

B ↑

B' ↑

C ←

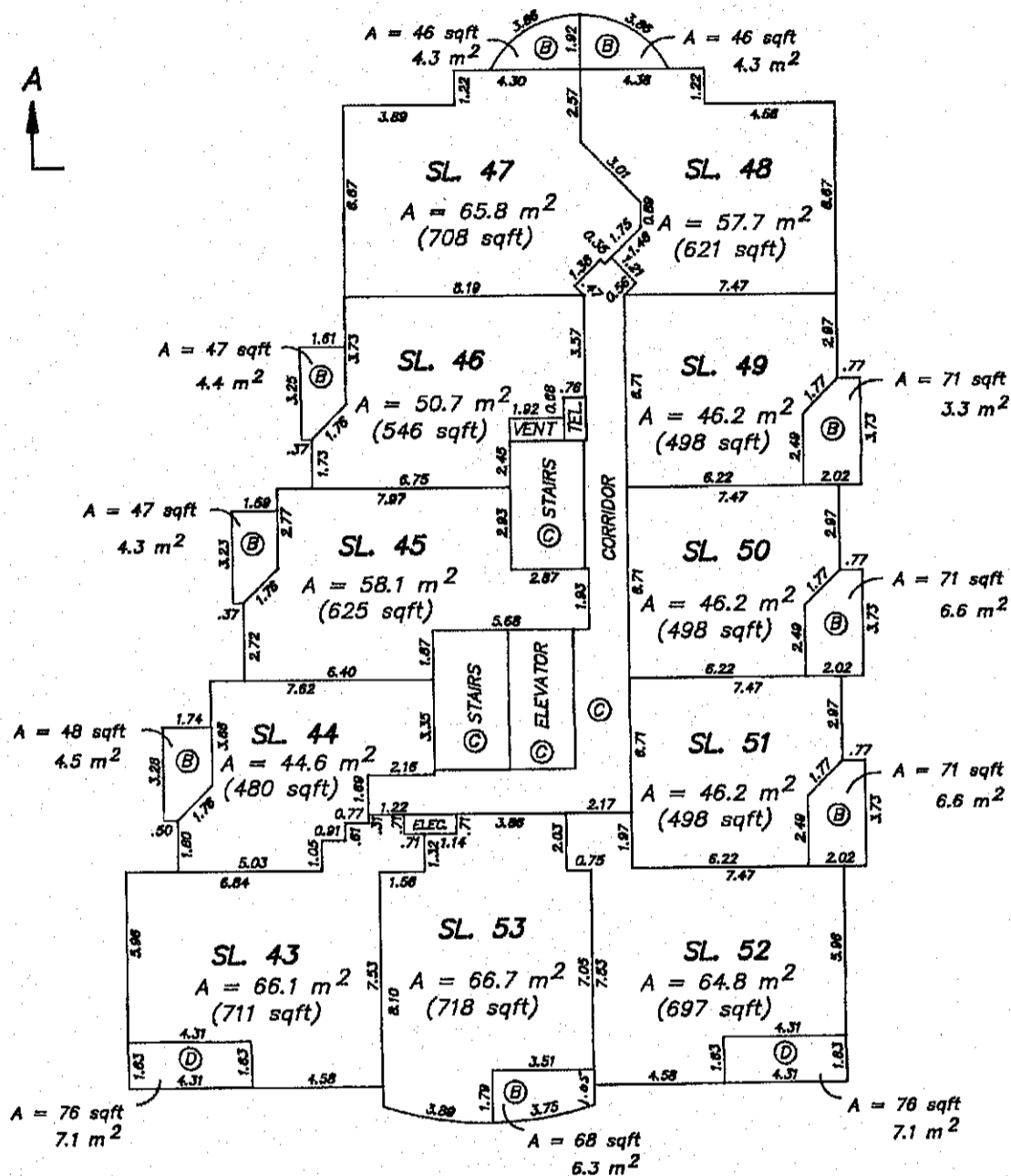

DATED THIS 21<sup>ST</sup> OF  
 JUN 1998  
 B.C.L.S.  
 E. 108H14

SIXTH FLOOR PLAN

STRATA PLAN LMS 155B

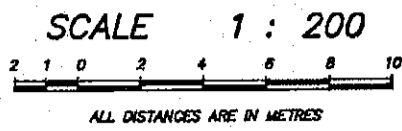

C' ←

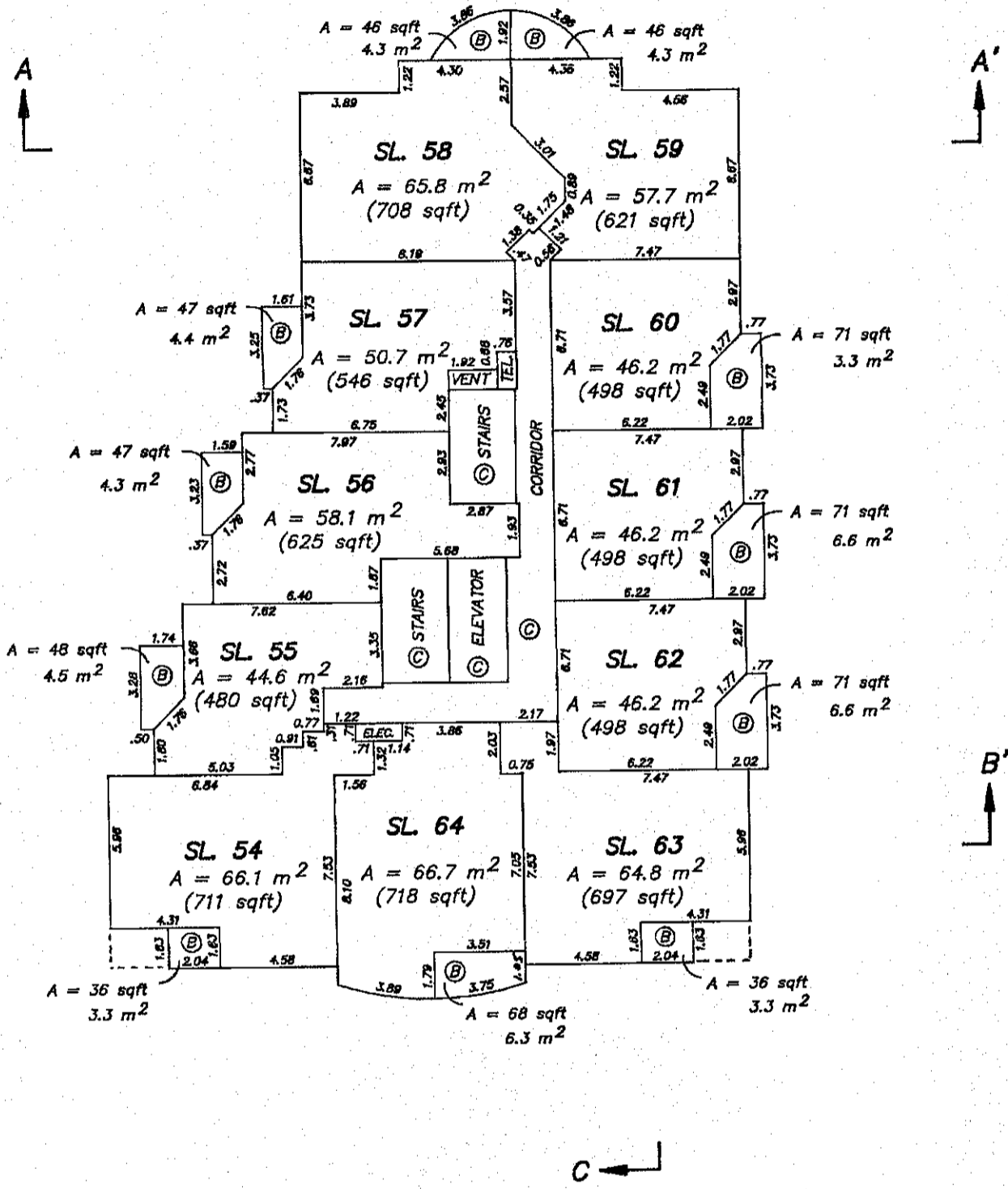

← C

DATED THIS 21<sup>ST</sup> DAY OF  
 JUN 1988  
 [Signature] B.C.L.S.  
 FILE: 08H15

FILED LMS1558 691841 2001-09-10-08:47:13.793827





EIGHTH FLOOR PLAN

STRATA PLAN LMS 1558

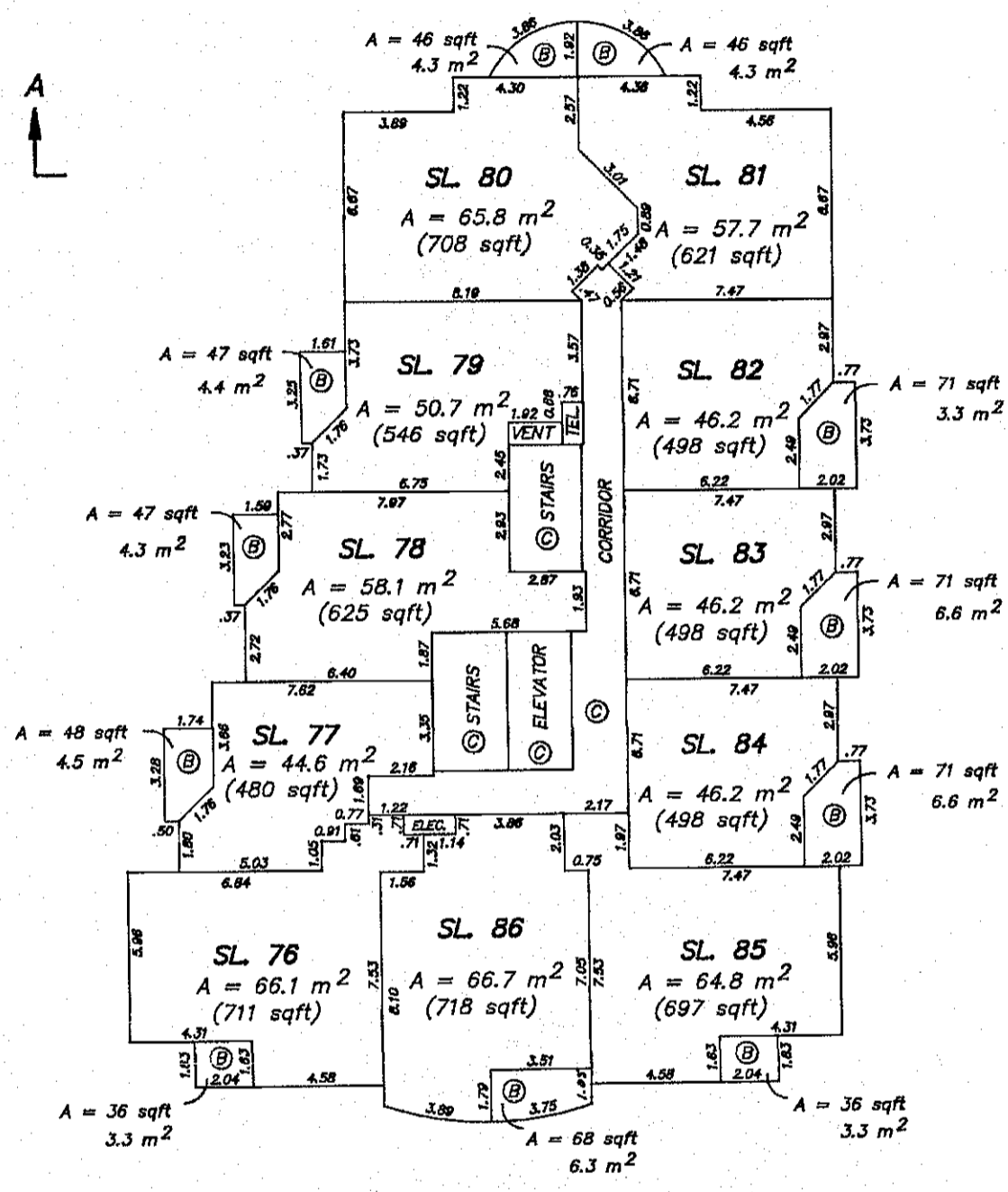
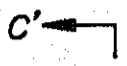
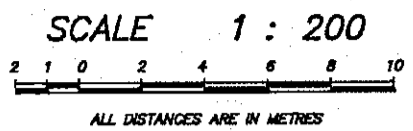

FILED LMLMS1558 691841 2001-09-10-08.47.13.793827

DATED THE 21 DAY OF  
 Ju  
 B.C.L.S.  
 E: 08H17

NINTH FLOOR PLAN

STRATA PLAN LMS 1558

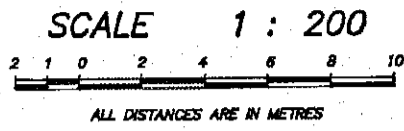

C' ←

A ↑

A' ↑

B ↑

B' ↑

C ←

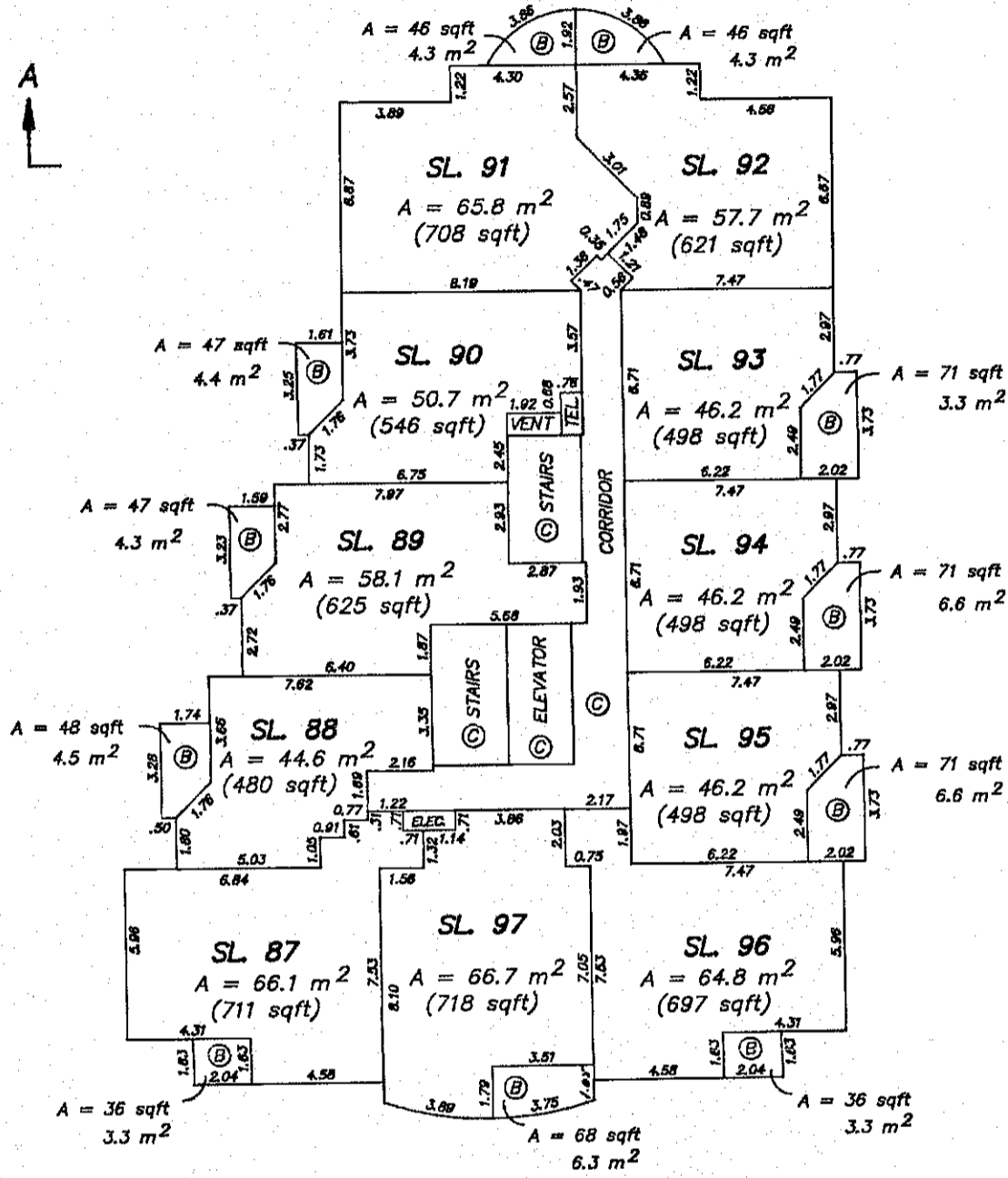

DATED THE 21<sup>ST</sup> DAY OF  
 JUNE  
 B.C.L.S.  
 FILE 2608H18

FILED LMLMS1558 691841 2001-09-10-08.47.13.793827

TENTH FLOOR PLAN

STRATA PLAN LMS 1558

SCALE 1 : 200



ALL DISTANCES ARE IN METRES

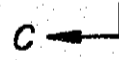
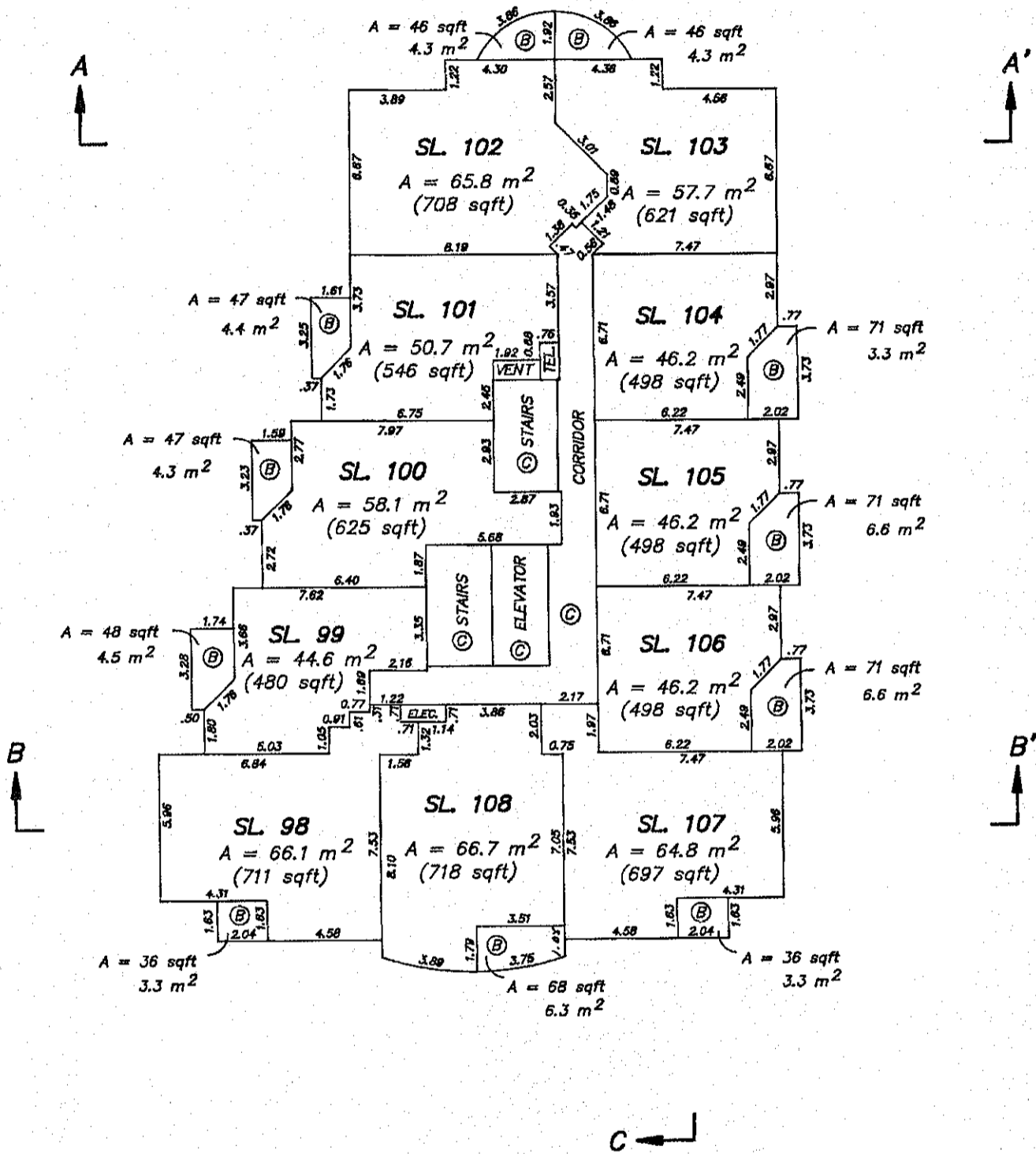
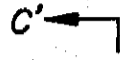

DATED 7 21 DAY OF  
J U N E 1984  
B.C.L.S.  
FILE 6608H19

ELEVENTH FLOOR PLAN

STRATA PLAN LMS 1558

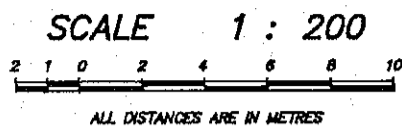

C' ←

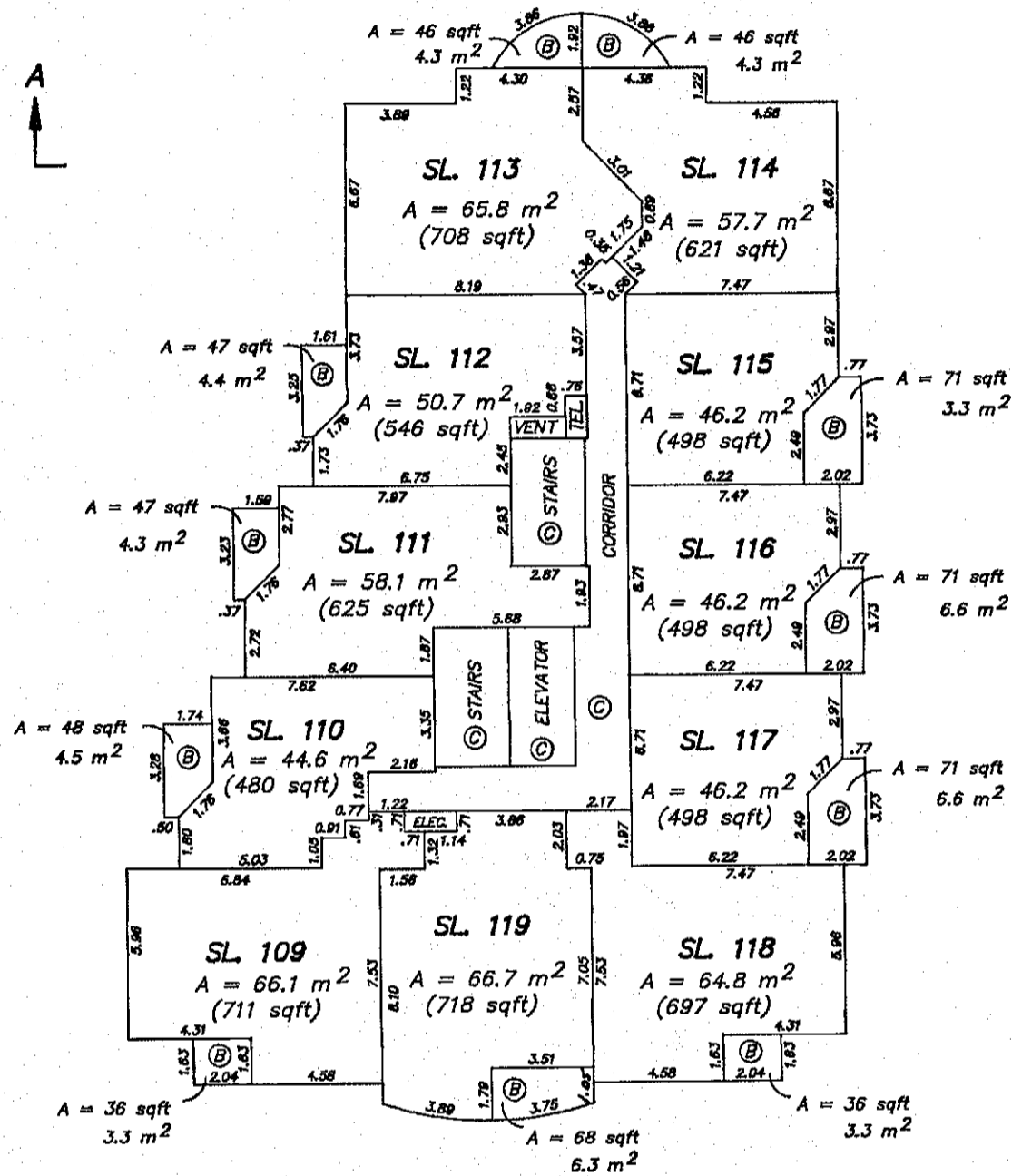

B ↑

B' ↑

C ←

FILED LMLMS1558 691841 2001-09-10-08:47:13:793827

DATED 21 MAY OF

*[Signature]*

B.C.L.S.

FILE: 2608H20

TWELVETH FLOOR PLAN

STRATA PLAN LMS 1558

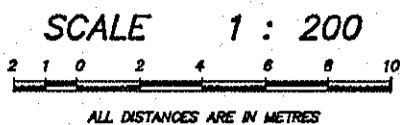

C' ←

A ↑

A' ↑

B ↑

B' ↑

C ←

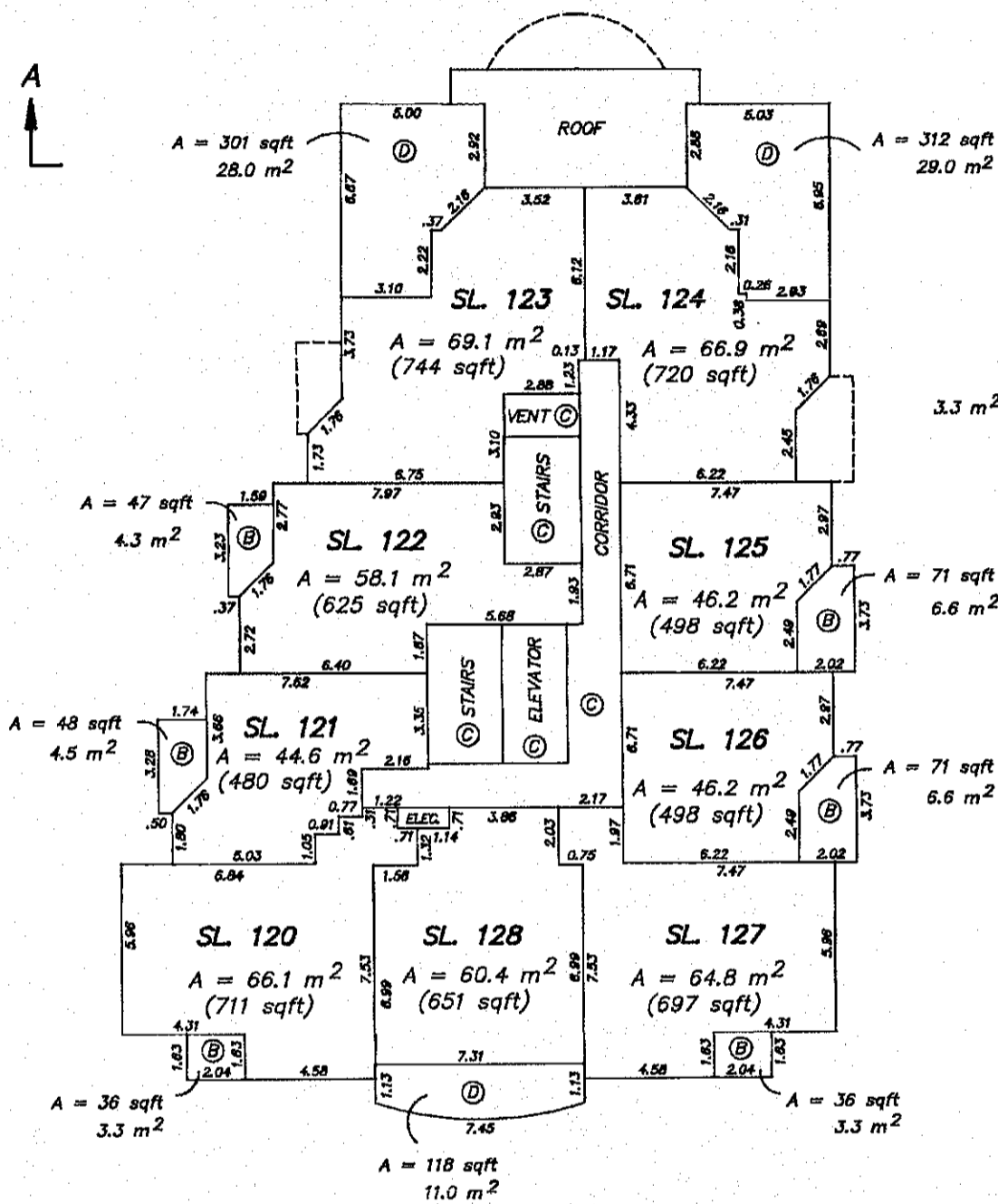

DATED 21st DAY OF  
 JULY 2001  
 B.C.L.S.  
 FILE 2608H21

THIRTEENTH FLOOR PLAN

STRATA PLAN LMS 1558

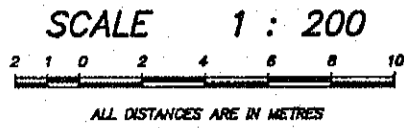

C' ←

A ↑

A' ↑

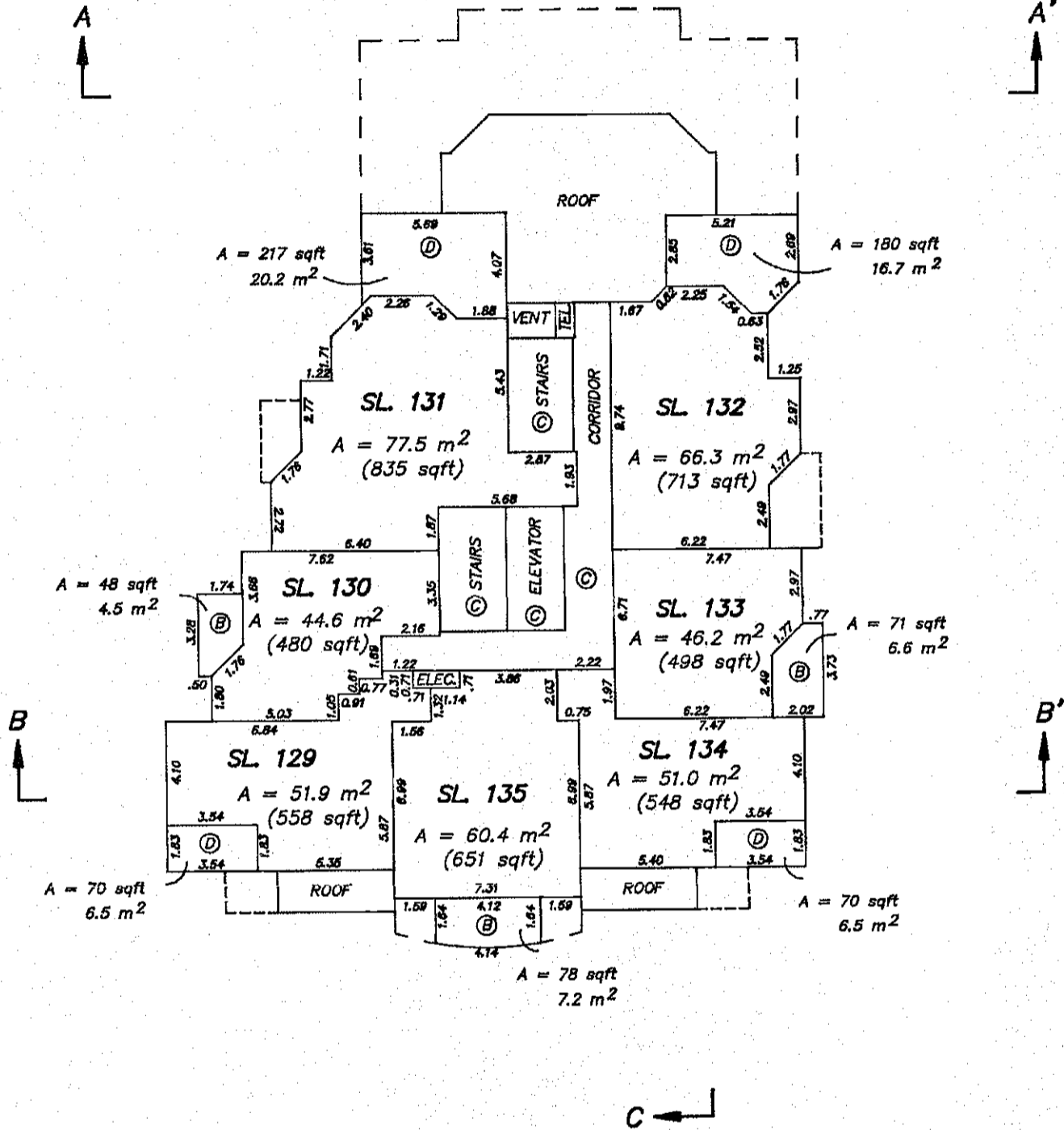

C ←

DATED THIS 21st DAY OF  
JULY 1994  
B.C.L.S.  
LE 1608H22

FOURTEENTH FLOOR PLAN

STRATA PLAN LMS 1558

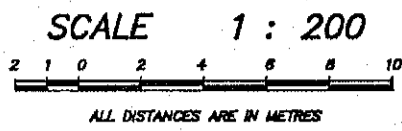

C' ←

A ↑

A' ↑

B ↑

B' ↑

C ←

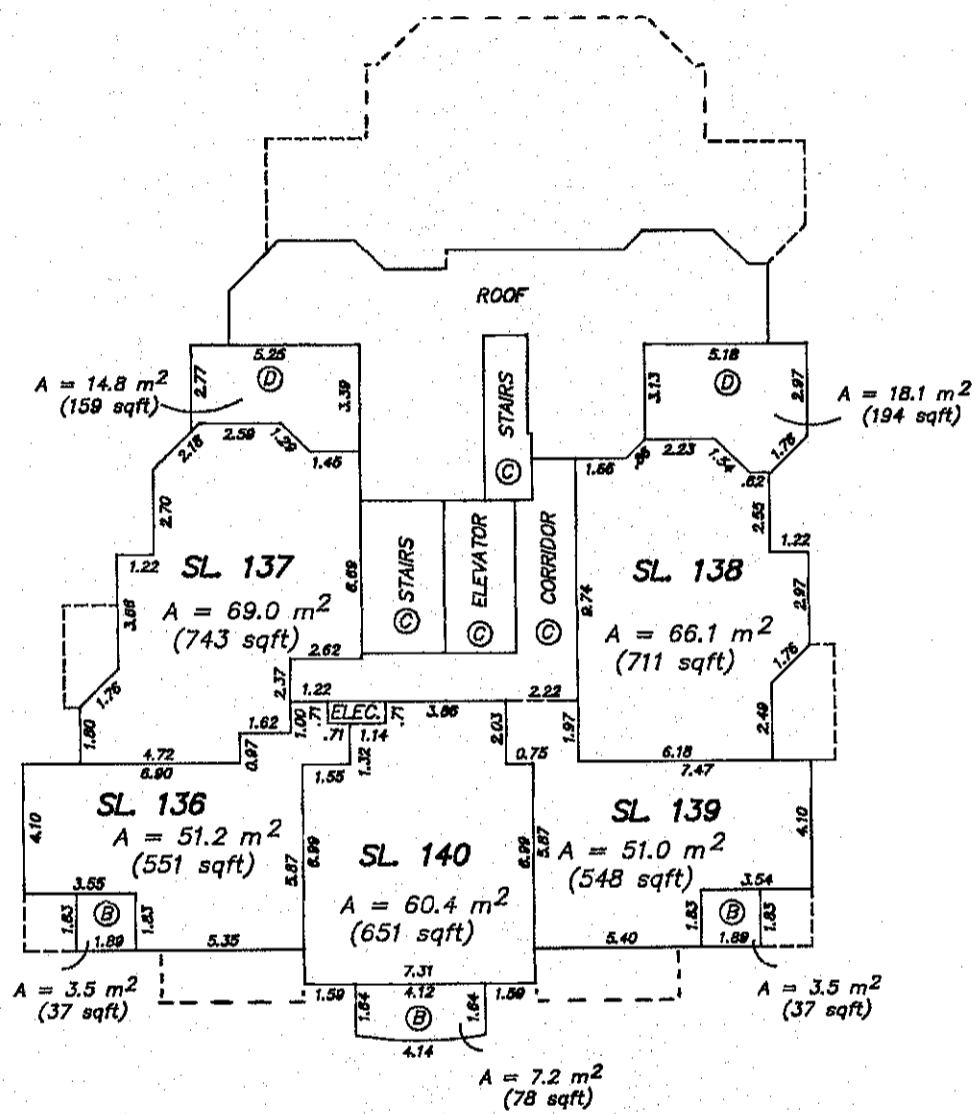

FILED LMS1558 691841 2001-09-10-08 47.13.793827

DATED 21st DAY OF JULY 2001

*[Signature]* B.C.L.S.

E: 08H23

STRATA PLAN LMS 1558

SECTION PLAN

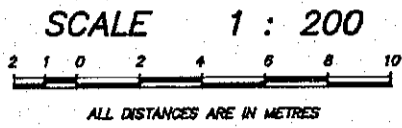

PARKING LEVEL P1	69	PARKING AISLE	ⓐ
PARKING LEVEL P2	103	PARKING AISLE	ⓒ

12 <sup>th</sup> FLOOR	ⓐ L.G.P. S.L. 123	ⓒ ROOF	ⓓ L.G.P. S.L. 124
11 <sup>th</sup> FLOOR	S.L. 113		S.L. 114
10 <sup>th</sup> FLOOR	S.L. 102		S.L. 103
9 <sup>th</sup> FLOOR	S.L. 91		S.L. 92
8 <sup>th</sup> FLOOR	S.L. 80		S.L. 81
7 <sup>th</sup> FLOOR	S.L. 69		S.L. 70
6 <sup>th</sup> FLOOR	S.L. 58		S.L. 59
5 <sup>th</sup> FLOOR	S.L. 47		S.L. 48
4 <sup>th</sup> FLOOR	S.L. 36		S.L. 37
3 <sup>rd</sup> FLOOR	S.L. 25		S.L. 26
2 <sup>nd</sup> FLOOR	S.L. 14		S.L. 15
GROUND FLOOR	S.L. 4		S.L. 5

SECTION A - A'

DATED 21<sup>st</sup> MAY OF  
 JUNE 2001  
 B.C.L.S.  
 FILE: 608H26





STRATA PLAN LMS 1558

SECTION PLAN

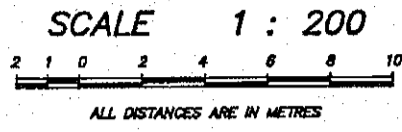

14 <sup>th</sup> FLOOR	S.L. 139	S.L. 138		ⓐ	ROOF	ⓑ	ROOF	ⓓ
	S.L. 134	S.L. 133	S.L. 132					
13 <sup>th</sup> FLOOR	S.L. 127	S.L. 126	S.L. 125	S.L. 124	ⓐ	ROOF	ⓓ	
12 <sup>th</sup> FLOOR	S.L. 118	S.L. 117	S.L. 116	S.L. 115				
11 <sup>th</sup> FLOOR	S.L. 107	S.L. 106	S.L. 105	S.L. 104	S.L. 103	ⓐ	ROOF	
10 <sup>th</sup> FLOOR	S.L. 96	S.L. 95	S.L. 94	S.L. 93	S.L. 92			
9 <sup>th</sup> FLOOR	S.L. 85	S.L. 84	S.L. 83	S.L. 82	S.L. 81	ⓐ	ROOF	
8 <sup>th</sup> FLOOR	S.L. 74	S.L. 73	S.L. 72	S.L. 71	S.L. 70			
7 <sup>th</sup> FLOOR	S.L. 63	S.L. 62	S.L. 61	S.L. 60	S.L. 59	ⓐ	ROOF	
6 <sup>th</sup> FLOOR	S.L. 52	S.L. 51	S.L. 50	S.L. 49	S.L. 48			
5 <sup>th</sup> FLOOR	S.L. 41	S.L. 40	S.L. 39	S.L. 38	S.L. 37	ⓐ	ROOF	
4 <sup>th</sup> FLOOR	S.L. 30	S.L. 29	S.L. 28	S.L. 27	S.L. 26			
3 <sup>rd</sup> FLOOR	S.L. 19	S.L. 18	S.L. 17	S.L. 16	S.L. 15	ⓐ	ROOF	
2 <sup>nd</sup> FLOOR	S.L. 9	S.L. 8	S.L. 7	S.L. 6	S.L. 5			
GROUND FLOOR	CORRIDOR		ELEC. ROOM	PARKING AISLE		52		
PARKING LEVEL P1	2	54	37	46	86			
PARKING LEVEL P2	122	121	104	168	86			

SECTION C - C'

DATED 21<sup>st</sup> MAY OF  
 JUNE  
 B.C.L.S.  
 FILE: 608H28



Search ALTO62 or BC OnLine for Current Information. BC Reg. 76/95

*Linda J. O'Shea*

LINDA J. O'SHEA, Registrar  
Victoria/New Westminster Land Title Districts

STRATA PLAN LMS 1558

DEALINGS AFFECTING THE COMMON PROPERTY

REGISTRATION		DOCUMENT	
NUMBER	DATE	DATE	NATURE AND PARTICULARS
HERETO IS ANNEXED EASEMENT BG60250 OVER LOT 1			
PLAN LMP5831 (PARTIAL RELEASE BG73865 03-03-1993 AS			
TO STRATA LOTS 1 TO 24 STRATA PLAN LMS 751 CANCELLED AS			
TO ALL EXCEPT PART IN PLAN LMP8180 BY BG446492			
10-12-1993	L.J. O'SHEA/PM		MODIFIED BY BH307948
HERETO IS ANNEXED EASEMENT BG60251 OVER LOT 2			
PLAN LMP5831 (PARTIAL RELEASE BG111656 02-04-1993 AS			
TO STRATA LOTS 1 TO 85 STRATA PLAN LMS 784 CANCELLED AS			
TO ALL EXCEPT PART IN PLAN LMP8180 BY BG446493			
10-12-1993	L.J. O'SHEA/PM		MODIFIED BY BH307949
HERETO IS ANNEXED EASEMENT BG60257 OVER LOT 2			
PLAN LMP5831 (PARTIAL RELEASE BG111697 02-04-1993 AS			
TO STRATA LOTS 1 TO 85 STRATA PLAN LMS 784 CANCELLED AS			
TO ALL EXCEPT PART IN PLAN LMP13195 BY BG446491			
10-12-1993	L.J. O'SHEA/PM		
HERETO IS ANNEXED EASEMENT BG60258 OVER LOT 3			
PLAN LMP5831-PARTIAL RELEASE BH337533 15/09/94 AS TO STRATA LOTS 1 TO 67			
STRATA PLAN LMS 1557 EXCEPT THE COMMON PROPERTY			
HERETO IS ANNEXED EASEMENT BG60260 OVER LOT 5			
PLAN LMP5831 PARTIAL RELEASE BH108472 30-03-1994			
AS TO STRATA LOTS 1-150 STRATA PLAN LMS 1299			
HERETO IS ANNEXED EASEMENT BH89470 OVER LOT 5			
PLAN LMP5831 PARTIAL RELEASE BH102999 29-03-1994			
AS TO STRATA LOTS 1 TO 150 STRATA PLAN LMS 1299			
HERETO IS ANNEXED EASEMENT BH307947 OVER THE			
COMMON PROPERTY OF STRATA PLAN LMS 1299			
BG60253	22-02-1993		EASEMENT
			APPURTENANT TO LOTS 1,
			2, 3, AND 5 PLAN LMP5831
			CANCELLED BY BG77468
			08-03-1993 AS TO LOT 1
			NOW STRATA PLAN LMS 751
			ALL EXCEPT THE COMMON
			PROPERTY CANCELLED BY
			BG111701 02-04-1993
			AS TO LOT 2 NOW STRATA
			PLAN LMS 784 ALL EXCEPT
			THE COMMON PROPERTY
			PARTIAL RELEASE BH103008
			29-03-1994 @ 9:05 AS TO
			STRATA LOTS 1 TO 150 STRATA
			PLAN LMS 1299
			MODIFIED BY BH307951
			INTER ALIA
			PARTIAL RELEASE BH337522 15/09/94 ON TO STRATA LOTS 1 TO 67
			STRATA PLAN LMS 1557 EXCEPT THE COMMON PROPERTY

CONT'D 28 A

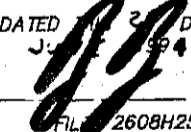
DATED 22 DAY OF JUN 1994  
  
 B.C.L.S.  
 FILE 2608H25

FILED LMS1558 691841 2001-09-10-08:47:13 793827

Common Property Sheet Closed 4/1/96

Search ALTOS2 or BC OnLine for Current Information. BC Reg. 76/95

STRATA PLAN LMS 1558

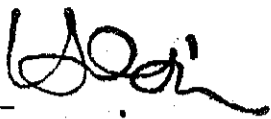

LINDA J. O'SHEA  
Vancouver/New Westminster Land Title Districts

DEALINGS AFFECTING THE COMMON PROPERTY

REGISTRATION		DOCUMENT	
NUMBER	DATE	DATE	NATURE AND PARTICULARS
DG 60259	22.02.1993		EASEMENT APPURTENANT TO LOTS 1, 2, 3 AND 5 PLAN LMS 5831 CANCELLED DG 77467 08.03.1993 AS TO LOT 1 NOW STRATA PLAN LMS 751 ALL EXCEPT THE COMMON PROPERTY CANCELLED BY DG 111702 02.04.1993 AS TO LOT 2 NOW STRATA PLAN LMS 784 ALL EXCEPT THE COMMON PROPERTY
			PARTIAL RELEASE BH 337536 15/09/94 DO NOT STRATA LOTS 1 TO 67 STRATA PLAN LMS 1557 EXCEPT THE COMMON PROPERTY
			PARTIAL RELEASE BH 103009 29.03.1994 @ 9:05 AS TO STRATA LOTS 1 TO 150 STRATA PLAN LMS 1259 INTER ALIA
BH 186233	19.05.1994		STATUTORY RIGHT OF WAY BRITISH COLUMBIA HYDRO AND POWER AUTHORITY INTER ALIA
BH 307951	19.08.1994		EASEMENT MODIFICATION OF DG 60253 (SEE BH 307918) INTER ALIA
			CANCELLED BH 337522 15/09/94 11:29 L.O'SHEA LATER
BH 307954	19.08.1994		EASEMENT PLAN LMP 18471 APPURTENANT TO LOT 3 PLAN LMS 5831 INTER ALIA
			PARTIAL RELEASE BH 337530 15/09/94 DO NOT STRATA LOTS 1 TO 67 STRATA PLAN LMS 1557 EXCEPT THE COMMON PROPERTY
BH 307957	19.08.1994		LEASE 431691 BRITISH COLUMBIA LTD. (INC # 431691) PARKING STALL # 42 PLAN LMP 18472
BH 307958	19.08.1994		LEASE 431691 BRITISH COLUMBIA LTD (INC # 431691) PARKING STALL # 43 PLAN LMP 18472
BH 307959	19.08.1994		LEASE 431691 BRITISH COLUMBIA LTD (INC # 431691) PARKING STALL # 49 PLAN LMP 18472

CONT'D 28 B

DATED THIS 21 DAY OF  
OCT 1994  
B.C.L.S.  
FILE # 288811

FILED LMS1558 691841 2001-09-10-08:47:13:793827

Search ALTOS2 or BC OnLine for  
Current Information. BC Reg. 76195

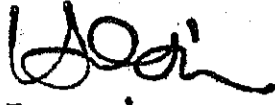

LINDA J. O'SHEA, Registrar  
Vancouver/New Westminster Land Title Districts

STRATA PLAN LMS 1558

DEALINGS AFFECTING THE COMMON PROPERTY

REGISTRATION		DOCUMENT	
NUMBER	DATE	DATE	NATURE AND PARTICULARS
BH307960	19-08-1994		LEASE 431691 BRITISH COLUMBIA LTD (INC. # 431691) PARKING STALL #50 PLAN LMP 18472
BH307961	19-08-1994		LEASE 431691 BRITISH COLUMBIA LTD. (INC. # 431691) PARKING STALL #69 PLAN LMP 18472
BH307962	19-08-1994		LEASE 431691 BRITISH COLUMBIA LTD. (INC. # 431691) PARKING STALL #70 PLAN LMP 18472
BH307963	19-08-1994		LEASE 431691 BRITISH COLUMBIA LTD (INC. # 431691) PARKING STALL #82 PLAN LMP 18472
BH307965	19-08-1994		LEASE 431691 BRITISH COLUMBIA LTD. (INC. # 431691) PARKING STALL #103 PLAN LMP 18473
BH307966	19-08-1994		LEASE 431691 BRITISH COLUMBIA LTD. (INC. # 431691) PARKING STALL #116 PLAN LMP 18473
BH307967	19-08-1994		LEASE 431691 BRITISH COLUMBIA LTD. (INC. # 431691) PARKING STALL #117 PLAN LMP 18473
BH307968	19-08-1994		LEASE 431691 BRITISH COLUMBIA LTD. PARKING STALL #119 PLAN LMP 18473

CONT ID SHEET 280

DATED THIS 21 DAY OF

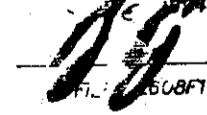
 B.C.L.S.  
FILE # 260877

FILED LMS1558 691841 2001-09-10-08:47:13 793827

