

08-328

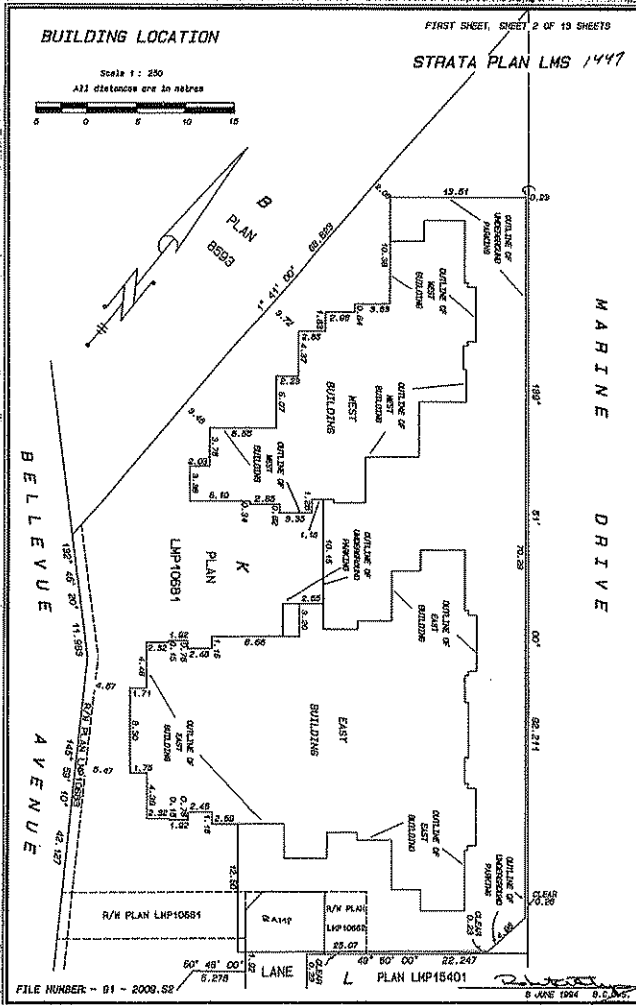

CONDOMINIUM ACT
SECOND SHEET, SHEET 9 OF 13 SHEETS
STRATA PLAN LMS 1447

LOT	SHEET	FORM 1	FORM 2	FORM 3
		SCHEDULE OF UNIT ENTITLEMENT UNIT ENTITLEMENT	SCHEDULE OF INTEREST UPON DESTRUCTION INTEREST UPON DESTRUCTION	SCHEDULE OF VOTING RIGHTS NUMBER OF VOTES
1	5	350	354	
2	6, 11	350	354	
3	6	353	373	
4	6, 11	353	359	
5	7	351	377	
6	7, 11	351	377	
7	7, 10	354	347	
8	7, 10, 11	355	320	
9	7	340	304	
10	7, 11	340	313	
11	8, 10	432	476	
12	8, 10, 11	433	457	
13	8	350	329	
14	8, 11	350	339	
15	8, 10	443	402	
16	8, 10, 11	424	455	
17	9	344	328	
18	8, 11	345	338	
19	8, 10	345	363	
20	7, 10	345	359	
21	7, 10, 11	380	399	
22	7, 11	359	320	
23	8, 10	345	377	
24	8, 10, 11	355	339	
25	8, 11	353	334	
26	8, 10, 11	431	412	
27	8, 11	259	202	
AGGREGATE		10,000	10,000	

CERTIFICATE UNDER SECTION 8(1)

I, ROBERT G. FLYNN OF LADNER B.C., A BRITISH COLUMBIA LAND SURVEYOR, HEREBY CERTIFY THAT THE OUTGOING SHOWN IN THIS STRATA PLAN HAS NOT, AS OF THE 8TH DAY OF JUNE, 1994 BEEN PREVIOUSLY OCCUPIED, DATED AT VANCOUVER, B.C. THIS 8TH DAY OF JUNE, 1994.

FILE NUMBER: - 91 - 2009.S3

CONDOMINIUM ACT

SECOND SHEET, SHEET 4 OF 13 SHEETS
STRATA PLAN LMS 1447

ACCEPTED AS TO FORMS 1, 2 AND-8
 THIS 13 DAY OF June 1994

Michael
 SUPERINTENDENT OF REAL ESTATE

STATUTORY DECLARATION

I, THE UNDERSIGNED DO SOLEMNLY DECLARE THAT
 (1) THE UNDERSIGNED IS THE ONLY AUTHORIZED
 AGENT OF THE OWNER - DEVELOPER
 (2) THE STRATA PLAN IS ENTIRELY FOR
 RESIDENTIAL USE

DECLARED BEFORE ME AT
 VANCOUVER IN THE PROVINCE
 OF BRITISH COLUMBIA,
 THIS 13 DAY OF JUNE 1994

I MAKE THIS SOLEMN DECLARATION CONSCIENTIOUSLY
 BELIEVING IT TO BE TRUE AND KNOWING THAT
 IT IS OF THE SAME FORCE AND EFFECT
 AS IF MADE UNDER OATH.

Thomas E. Baines
 A COMMISSIONER FOR THE TAKING
 OF AFFIDAVITS IN AND FOR THE
 PROVINCE OF BRITISH COLUMBIA
THOMAS E. BAINE

Howard A. Bostrom
 AGENT FOR OWNER - DEVELOPER
HOWARD A. BOSTROM

OWNERS:-

377467 BRITISH COLUMBIA LTD.
 (INCORPORATION # 977467)

Howard A. Bostrom
 AUTHORIZED SIGNATORY
HOWARD A. BOSTROM

WITNESSES AS TO BOTH SIGNATURES

Thomas E. Baines
 THOMAS E. BAINE WITNESS
 1900 - 1055 WEST 65TH AVENUE ST.
 VANCOUVER, B.C. V6E 4P2
 ADDRESS OF WITNESS

LAWYER
 OCCUPATION OF WITNESS

CHARGEHOLDER:-

HERS KOIS BANK OF CANADA

Paul Kordach
 AUTHORIZED SIGNATORY
PAUL KORDACH

WITNESSES AS TO BOTH SIGNATURES

Thomas E. Baines
 THOMAS E. BAINE WITNESS
 1900 - 1055 WEST 65TH AVENUE ST.
 VANCOUVER, B.C. V6E 4P2
 ADDRESS OF WITNESS

LAWYER
 OCCUPATION OF WITNESS

CHARGEHOLDERS:-

INSTAFUND FINANCIAL SERVICES LTD.

MONTREAL TRUST COMPANY OF CANADA

Edward Korbina
 AUTHORIZED SIGNATORY
EDWARD KORBINA

WITNESSES AS TO BOTH SIGNATURES

Carol Colman
 WITNESS
Carol Colman

330 - 1055 W. 65TH ST.
 VANCOUVER, B.C. V6E 4P2
 ADDRESS OF WITNESS

Olivia Adams
 WITNESS
Olivia Adams

Nina N. Clemons
 AUTHORIZED SIGNATORY
NINA N. CLEMONS

WITNESSES AS TO BOTH SIGNATURES

James Adams
 WITNESS
James Adams

510 AVENUE ST - VANCOUVER
 V6C 8B9 ADDRESS OF WITNESS

ADMINISTRATIVE ASSISTANT
 OCCUPATION OF WITNESS

Michael
 9 JUNE 1994 B.C.L.P.

**130' LEVEL
 FLOOR PLANS**

SHEET 5 OF 13 SHEETS
STRATA PLAN LMS 1447

Scale 1 : 250
 All distances are in metres

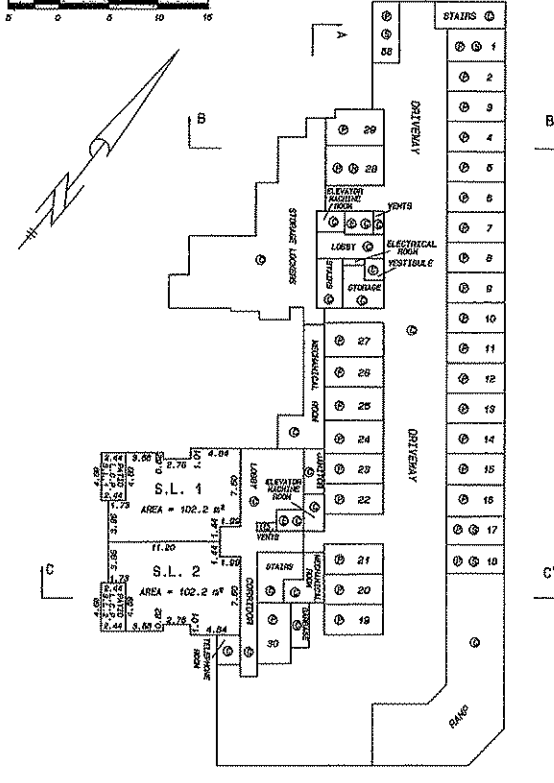

- ⊙ LOCKERS AND PARKING STALLS ARE ALL COMMON PROPERTY
- ⊙ DENOTES NUMBERED PARKING STALL
- ⊙ DENOTES SMALL CAR PARKING STALL
- ⊙ DENOTES HANDICAPPED PARKING STALL

Michael
 9 JUNE 1994 B.C.L.P.

**140' LEVEL
 FLOOR PLANS**

SHEET 6 OF 13 SHEETS
STRATA PLAN LMS 1447

Scale 1 : 250
 All distances are in metres

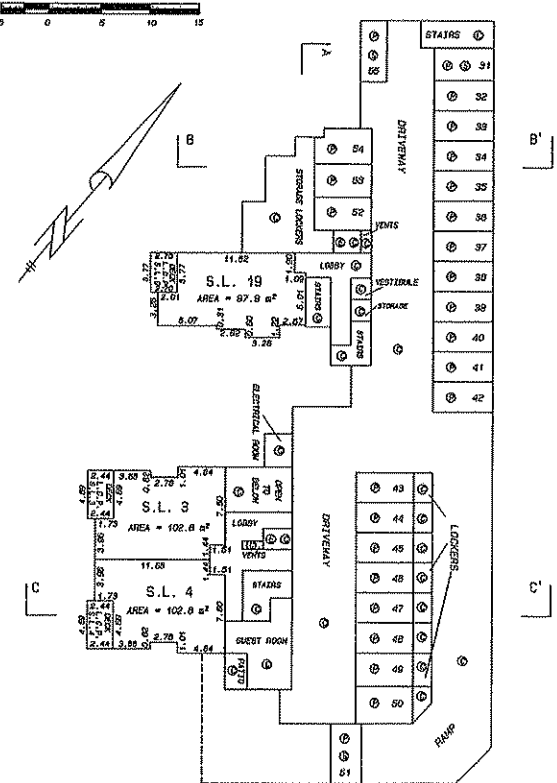

- ⊙ LOCKERS AND PARKING STALLS ARE ALL COMMON PROPERTY
- ⊙ DENOTES NUMBERED PARKING STALL
- ⊙ DENOTES SMALL CAR PARKING STALL

Michael
 9 JUNE 1994 B.C.L.P.

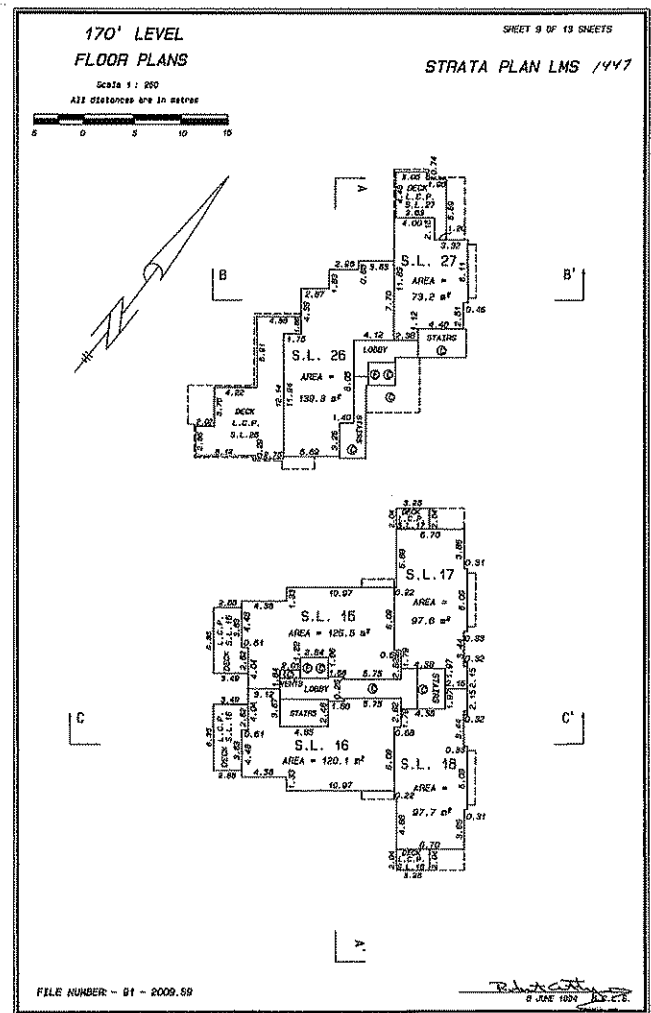
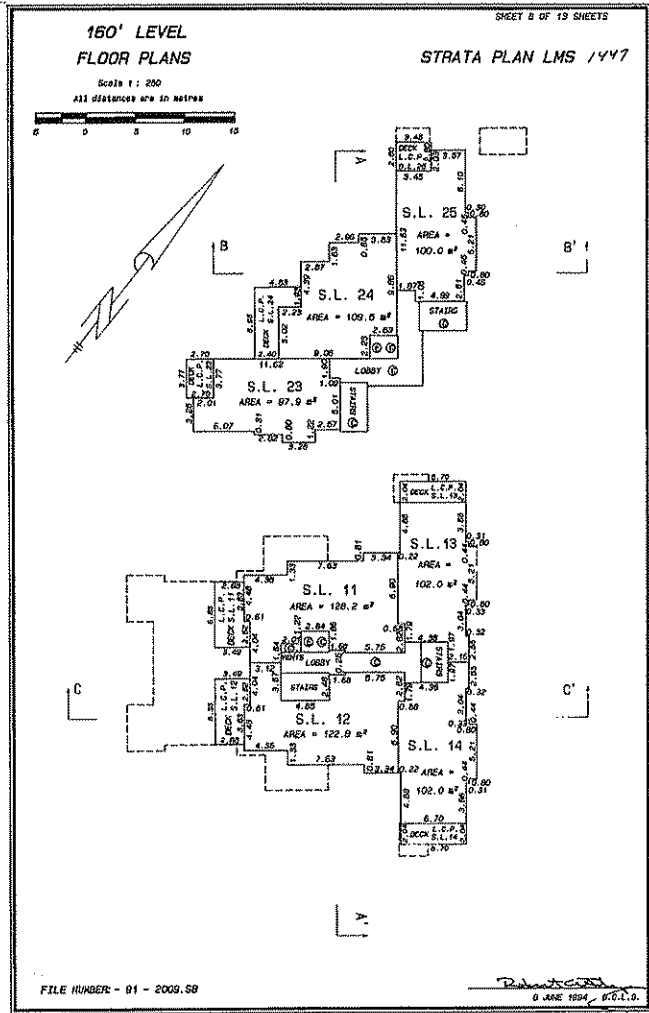
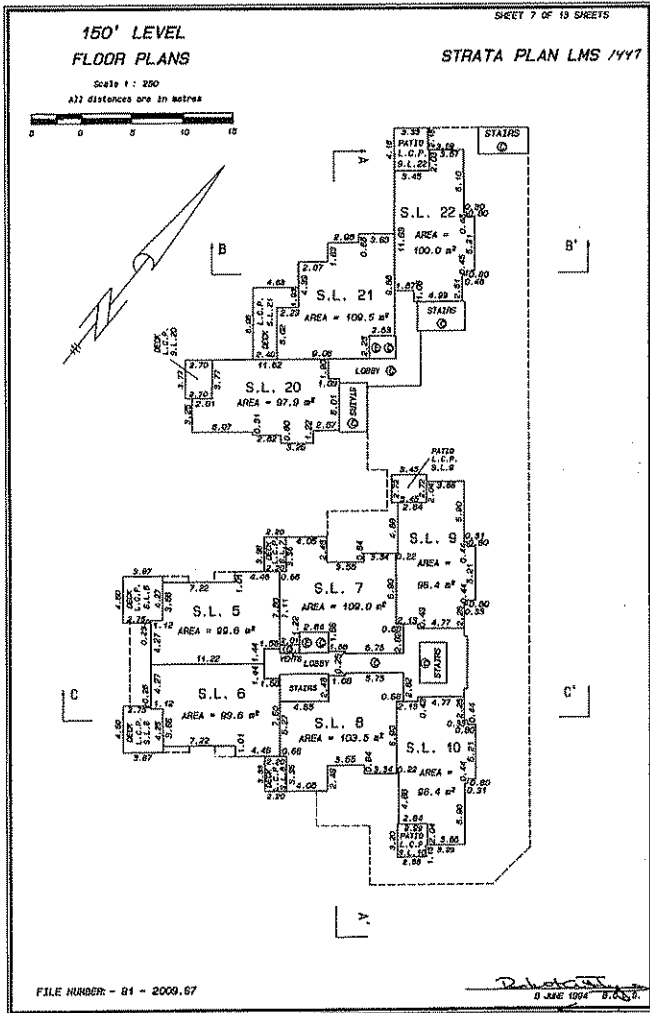

SECTIONS

SHEET 10 OF 13 SHEETS

SECTION A - A'

STRATA PLAN LMS 1447

Scale 1 : 250

All distances are in metres



170' LEVEL
160' LEVEL
150' LEVEL
140' LEVEL
130' LEVEL

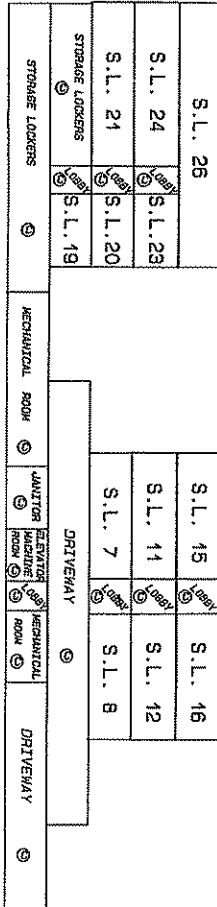

DRAGATI
8 JUNE 1994 P.L.S.

SECTIONS

SHEET 11 OF 13 SHEETS

STRATA PLAN LMS 1447

Scale 1 : 250

All distances are in metres

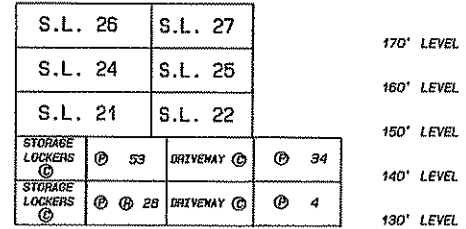

SECTION B - B'

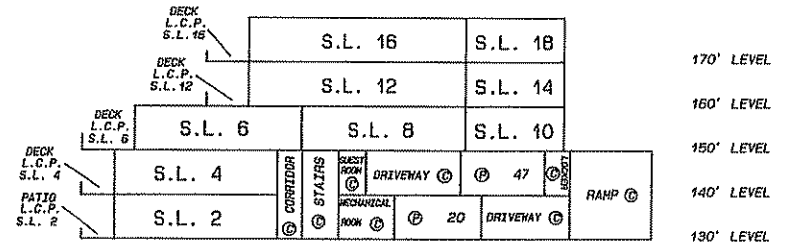

SECTION C - C'

- Ⓟ DENOTES NUMBERED PARKING STALL
- Ⓢ DENOTES HANDICAPPED PARKING STALL

DRAGATI
8 JUNE 1994 P.L.S.

