



ANN LOK
604-767-0959

#503-1501 HOWE ST.
VANCOUVER, B.C.

*TOTAL 1146 SQ. FT.

TERRACE 1175 SQ. FT.
BALCONY 19 SQ. FT.

*Area measurements taken from:
Strata Plan LMS 712, S.L.#45,
Dated: Dec. 2, 1992.

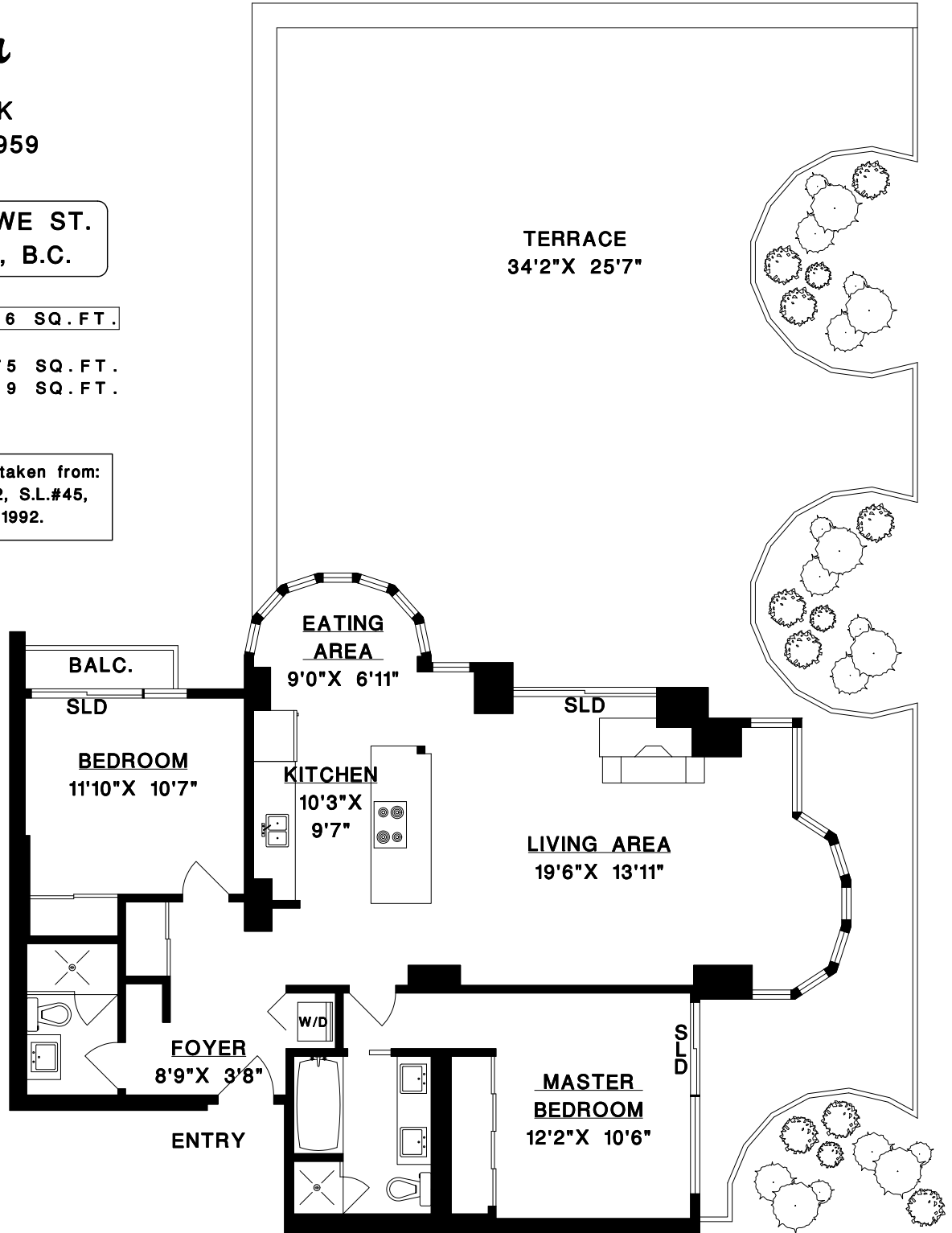

1' 6'
SCALE

MEASURE MASTERS
VAN/MBY/776-0788
(604) 931-8585

JAN. 2006