



Presented by:
Cindy E Gering PREC*
Royal LePage West R.E.S.
Phone: 604-779-1292
www.teamcindygering.com
cindy@teamcindygering.com



604.779.1292
cindy@teamcindygering.com
newwestcondo.com

Active
R2192107
Board: V
Apartment/Condo

201 1350 VIEW CRESCENT
Tsawwassen
Beach Grove
V4L 2K3

Residential Attached
\$599,800 (LP)
(SP)



Sold Date: Frontage (feet): **0.00** Original Price: **\$599,800**
Meas. Type: **Feet** Frontage (metres): **0.00** Approx. Year Built: **1983**
Depth / Size (ft.): **0** Bedrooms: **2** Age: **34**
Lot Area (sq.ft.): **0.00** Bathrooms: **1** Zoning: **RM6A**
Flood Plain: **No** Full Baths: **1** Gross Taxes: **\$1,956.74**
Approval Req?: **No** Half Baths: **0** For Tax Year: **2017**
Exposure: **Southeast** Maint. Fee: **\$474.00** Tax Inc. Utilities?: **No**
If new, GST/HST inc?: P.I.D.: **001-048-317**
Mgmt. Co's Name: **CROSSROADS MGMT LTD** Tour:
Mgmt. Co's Phone: **778-578-4445**
View: **Yes: BEACH GROVE GOLF COURSE**
Complex / Subdiv: **THE CLASSIC**
Services Connected: **Electricity, Natural Gas, Sanitary Sewer, Water**

Style of Home: **Corner Unit, Upper Unit**
Construction: **Concrete Frame**
Exterior: **Brick**
Foundation: **Concrete Perimeter**
Rain Screen:
Renovations: **Partly**
Water Supply: **City/Municipal**
Fireplace Fuel: **Gas - Natural**
Fuel/Heating: **Hot Water**
Outdoor Area: **Balcony(s)**
Type of Roof: **Metal, Other**

Reno. Year:
R.I. Plumbing: **No**
R.I. Fireplaces:
of Fireplaces: **1**

Total Parking: **1** Covered Parking: **1** Parking Access:
Parking: **Garage; Underground, Visitor Parking**
Locker: **Y**
Dist. to Public Transit: **1 BLOCK**
Units in Development: **72**
Title to Land: **Freehold Strata**
Dist. to School Bus: **1 BLOCK**
Total Units in Strata: **72**

Property Disc.: **Yes**
Fixtures Leased: **No**
Fixtures Rmvd: **No**
Floor Finish: **Laminate, Mixed**

Maint Fee Inc: **Caretaker, Garbage Pickup, Gardening, Gas, Heat, Hot Water, Management, Recreation Facility, Snow removal, Water**
Legal: **SL 12 SEC 11 TWP 5 NW 2211**

Amenities: **Exercise Centre, In Suite Laundry, Sauna/Steam Room, Storage, Wheelchair Access, Workshop Attached**

Site Influences: **Central Location, Golf Course Nearby, Greenbelt, Private Setting, Recreation Nearby, Shopping Nearby**
Features: **ClthWsh/Dryr/Frdg/Stve/DW, Drapes/Window Coverings, Smoke Alarm, Sprinkler - Fire**

| Floor | Type | Dimensions | Floor | Type | Dimensions | Floor | Type | Dimensions |
|-------|----------------|-------------|-------|------|------------|-------|------|------------|
| Main | Living Room | 19'8 x 13'3 | | | x | | | x |
| Main | Dining Room | 11'1 x 10'2 | | | x | | | x |
| Main | Kitchen | 9'9 x 7'10 | | | x | | | x |
| Main | Master Bedroom | 19'4 x 14'2 | | | x | | | x |
| Main | Bedroom | 12'7 x 10'0 | | | x | | | x |
| Main | Den | 6'8 x 6'11 | | | x | | | x |
| Main | Walk-In Closet | 6'1 x 10'8 | | | x | | | x |
| Main | Foyer | 5'4 x 8'8 | | | x | | | x |
| Main | Laundry | 7'4 x 9'8 | | | x | | | x |
| | | x | | | x | | | |

| | | | | | | | | | |
|----------------------------|----------------------|--|-------------------------|-----------------------|------|-------------|-------------|------------|----------------|
| Finished Floor (Main): | 1,513 | # of Rooms: 9 | # of Kitchens: 1 | # of Levels: 1 | Bath | Floor | # of Pieces | Ensuite? | Outbuildings |
| Finished Floor (Above): | 0 | Crawl/Bsmt. Height: | | | 1 | Main | 4 | Yes | Barn: |
| Finished Floor (Below): | 0 | Restricted Age: | | | 2 | | | | Workshop/Shed: |
| Finished Floor (Basement): | 0 | # of Pets: 1 | Cats: Y | Dogs: Y | 3 | | | | Pool: |
| Finished Floor (Total): | 1,513 sq. ft. | # or % of Rentals Allowed: 4 | | | 4 | | | | Garage Sz: |
| Unfinished Floor: | 0 | Bylaw Restrict: Pets Allowed w/ Rest., Rentals Allwd w/ Restrctns | | | 5 | | | | Door Height: |
| Grand Total: | 1,513 sq. ft. | Basement: None | | | 6 | | | | |
| | | | | | 7 | | | | |
| | | | | | 8 | | | | |

Listing Broker(s): **Royal LePage West R.E.S.**

OPEN HOUSE Thursday 6-7pm July 27th & Sunday 2-4pm July 30th! Stunning View Facing Beach Grove Golf Course! Rarely comes on the market! Corner unit SE Facing 2 bdrm & den plus 2 bthrms amazing light w/ floor to ceiling windows, large covered deck an extension of living space-great for BBQ & entertaining. Large grand LR/DR space can fit house-size furniture, spacious master bedroom w/ den & W/I closet. Bonus the 2nd bdrm is like a private suite w/ separate door between unit, bdrm & bthrm ideal for guests that need their private space. Bonus large insuite storage & laundry room. Amenities include gym, sauna, library, garden area, workshop, visitor parking & caretaker Close to Tsawwassen Mall, Centennial Beach, The Dyke, Golf Course, restaurants-ideal location! 1 locker/ 1 parking 1 pet ok.

#201 - 1350 View Crescent, Tsawwassen BC

\$599,800



Royal LePage West Real Estate Services | 2185 Austin Avenue, Coquitlam, BC, V3K 3R9
cell: **604-779-1292** | cindy@teamcindygering.com | web: www.teamcindygering.com



TEAM CINDYGERING
PERSONAL REAL ESTATE CORPORATION
604.779.1292 - Cindy@TeamCindyGering.com

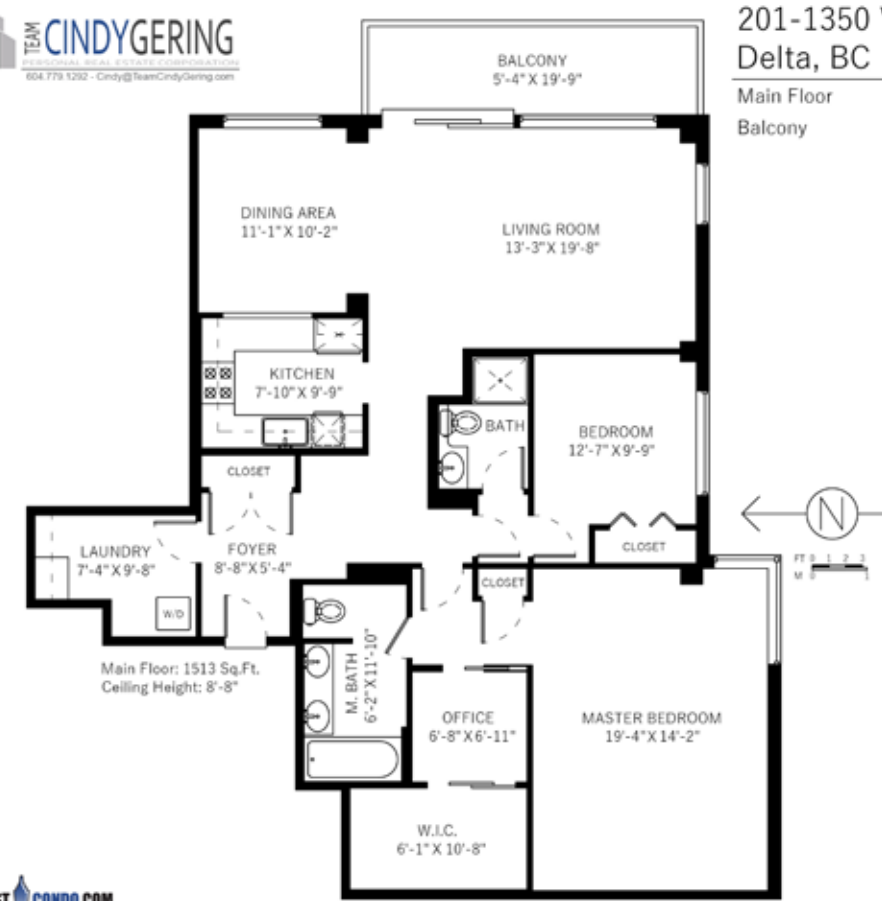

201-1350 View Cr
Delta, BC

Main Floor 1513 SQ.FT.
Balcony 116 SQ.FT.

NEWWEST CONDO.COM

Floor plan not suitable for architectural/construction purposes. ANDI Z115 standard used to calculate square footage. Buyer to verify.

SNOWCHIMP CREATIVE



#201 - 1350 View Crescent, Tsawwassen BC

\$599,800

| | |
|--------------|-------------------|
| Type: | Apartment |
| Total area: | 1513 sqft |
| Year built: | 1983 |
| Bedrooms: | 2 + Den |
| Bathrooms: | 2 |
| Maint. Fees: | \$474.00 |
| Taxes: | \$1,956.74 (2017) |

Stunning View Facing Beach Grove Golf Course! Rarely comes on the market! Corner unit SE Facing 2 Bdrm & Den plus 2 bthrms amazing light w/ floor to ceiling windows, lrg covered deck an extension of living space-great for BBQ & entertaining. Lrg grand LR/DR space can fit house-size furniture, spacious mstr bdrm w/ den & W/I closet. Bonus the 2nd bdrm is like a private suite w/ separate door between unit, bedroom & bathroom ideal for guests that need their private space. Bonus large insuite storage & laundry room. Amenities include gym, sauna, library, garden area, workshop, visitor parking & caretaker Close to Tsawwassen Mall, Centennial Beach, The Dyke, Golf Course, restaurants-ideal location! 1 locker/ 1 parking 1 pet OK.

